

KENT COUNTY COUNCIL
REGISTER OF DEPOSITS



KCC Reference number: **TH/ROW4/HQ/364**

- ✓ Highways Statement
- ✓ Landowner Statement
- ✓ Highways Declaration

Date application received: **21/01/2015**

Date on which any Highways Declaration expires: **13/02/2035**

.....

Details of the land:

District	Shepway
Parish	Lydd, New Romney, Old Romney, Ivychurch, St Mary in the Marsh, Newchurch, Brenzett, Ivychurch
Address & postcode of buildings on land parcels	Land at Culvers Lane, Lydd, TN29 9JE Land known as Dengemarsh Farmland, Lydd, TN29 9JX Land at Horses Bones Farm, Lydd, TN29 9PZ Land at New Romney, TN28 8SW Land at Warren Farm Dymchurch Road, New Romney, TN28 8UE Land adjoining Rhee Wall, Old Romney, TN29 9SY Land at Wenhams Lane, Ivychurch, TN29 0HS Land on the north-east and south-west sides of Pickneybush Lane, St Mary in the Marsh, TN29 0BY

	Land at Flaggsland, Newchurch, TN26 2QA Land at Lodgelands Farm, Newchurch Lane, Ruckinge, TN26 2QE
Nearest town/city + OS 6-figure grid reference	TR 049 194 - Lydd TR 055 210 - Lydd TR 033 217 - Lydd TR 067 236 - New Romney TR 076 257 - New Romney TR 024 257 - Old Romney TR 029 269 - Ivychurch TR 063 284 - St Mary in the Marsh TR 035 313 - Newchurch TR 038 298 - Newchurch

KCC Contact: Definitive Map Officer

Tel: 03000 41 71 71

Email: prow@kent.gov.uk

Form CA17

Notice of landowner deposit under section 31(6) of the Highways Act 1980 and/or section 15A(1) of the Commons Act 2006

The Kent County Council

An application to deposit a map and statement and subsequently lodge a declaration under section 31(6) of the Highways Act 1980 and deposit a statement under section 15A(1) of the Commons Act 2006 has been made in relation to the land described below and shown edged red on the accompanying map. Deposit applications enable a landowner to protect their land against the establishment of any/further public rights of way and/or registration of the land as a village green.

PLEASE NOTE:

This deposit does **not** affect existing recorded public rights of way but may affect unrecorded rights over the land described below. Deposits made under section 31(6) of the Highways Act 1980 may prevent deemed dedication of public rights of way over such land under section 31(1) of that Act. Deposits made under section 15A(1) of the Commons Act 2006 may affect the ability to register such land as a town or village green under section 15 of that Act. Please see guidance at:

<http://www.defra.gov.uk/rural/protected/greens/> for further information.

Description of the land:

Land at Culvers Lane, Lydd, TN29 9JE; land known as Dengemarsch Farmland, Lydd, TN29 9JX; Land at Horses Bones Farm, Lydd, TN29 9PZ; Land at New Romney, TN28 8SW; Land at Warren Farm Dymchurch Road, New Romney, TN28 8UE; Land adjoining Rhee Wall, Old Romney, TN29 9SY; Land at Wenhams Lane, Ivychurch, TN29 0HS; Land on the north-east and south-west sides of Pickneybush Lane, St Mary in the Marsh, TN29 0BY; Land at Flagglands, Newchurch, TN26 2QA; Land at Lodgelands Farm, Newchurch Lane, Ruckinge, TN26 2QE

Name of the Parish, Ward or District in which the land is situated:

Lydd, New Romney, Old Romney, Ivychurch, St Mary in the Marsh, Newchurch, Brenzett, Ivychurch in the District of Shepway

The deposit was submitted by Hugh, Joan, Alan & Colin Balcomb and was received by this authority on 21/01/2015.

The authority maintains a register of maps, statements and declarations deposited under section 31(6) of the Highways Act 1980 and section 15B of the Commons Act 2006.

This register can be accessed online at: <http://www.kent.gov.uk/waste-planning-and-land/public-rights-of-way/landowner-protection> or can be inspected free of charge at the address below at the times indicated below:

PROW & Access Service, Invicta House – County Hall, Maidstone, Kent, ME14 1XX
Monday-Friday between the hours of 10.00am-4.00pm. For further information on this subject or to make an appointment to view the register in the office, please contact **Mrs Maria McLauchlan** on 03000 413420.

Signed on behalf of **The Kent County Council**:



Name and Position of Signatory: Mike Overbeke,

Head of Public Protection

Date: 2nd March 2015



FORM CA16

PART A:

Information relating to the applicant and land to which the application relates

1. Name of appropriate authority to which the application is addressed:

Kent County Council.

2. Name and full address (including postcode) of applicant:

Mr Hugh Balcomb, Horses Bones Farm, Caldicott Lane, Lydd, Romney Marsh, Kent, TN29 9PZ.

Mrs Joan Balcomb, Horses Bones Farm, Caldicott Lane, Lydd, Romney Marsh, Kent, TN29 9PZ.

Mr Alan Balcomb, Horses Bones Farm, Caldicott Lane, Lydd, Romney Marsh, Kent, TN29 9PZ.

Mr Colin Balcomb, Horses Bones Farm, Caldicott Lane, Lydd, Romney Marsh, Kent, TN29 9PZ.

3. Status of applicant (tick relevant box or boxes):

~~Lam~~ WE ARE

(a) ☒ the owners of the land(s) described in paragraph 4.

(b) ☐ making this application and the statements/declarations it contains on behalf of[insert name of owner] who is the owner of the land(s) described in paragraph 4 and in my capacity as [insert details]

4. Insert description of the lands to which the application relates (including full address and postcode):

Please see the attached plan.

Land at Culvers Lane, Lydd, TN29 9JE: One field parcel located south of the southern end of Culvers Lane.

Dengemarsh Farmland, Lydd, TN29 9JX: Two field parcels, located to the south of Lydd railway line and to the north of Dungeness Road.

Land at Horses Bones Farm, Lydd, TN29 9PZ: One large parcel of land surrounding Horses Bones Farm, Lydd, together with two smaller parcels located to the north of Lydd Petty Sewer. Another block lies to the north east of Midley Wall, Romney Marsh. As indicated on the plan, several small areas to the north of the main parcel have been divided from the main parcel due to the presence of easements.

Land at New Romney, TN28 8SW: Two blocks of land, located to the south east of Station Approach, and to the south of Church Lane.

Warren Farm, Dymchurch Road, New Romney, TN28 8UE: Two blocks of land located to the south east of the A259, divided by tracks and drainage ditches. A further parcel lies to the north of the A259, accessed via a track from a neighbouring caravan site.

Land Adjoining Rhee Wall, Old Romney, Romney Marsh, TN29 9SY: Three parcels of land on the north east and south west sides of the A259.

Land at Wenhams Lane, Ivychurch, Romney Marsh, TN29 0HS: Three parcels of land bordered partly by drainage ditches, located on the west and east of Wenhams Lane, Ivychurch.

Land on the North East and South West Sides of Pickneybush Lane, St Mary in the Marsh, Romney, TN29 0BY: Two large parcels of land, located to the east of Pickneybush Lane and to the east of Chittenden's Lane.

Flaggsland, Newchurch, Romney Marsh, TN26 2QA: Single parcel of land located on the opposite side of the road to Langdon Cottages, bordered mostly by drainage ditches.

Lodgelands Farm, Newchurch Lane, Ruckinge, Ashford, TN26 2QE: Three large parcels and one smaller parcel of land at Ruckinge. The smallest parcel is located to the north east of the junction between Newchurch Lane and Melon Lane. The easternmost parcel is located to the east of Melon lane. The largest parcel is located between Melon lane and Newchurch Lane, surrounding and including Lodgeland Farm. The westernmost parcel is located to the west of Newchurch Lane, opposite Lodgeland Farm, bordered mostly by drainage ditches.

5. Ordnance Survey six-figure grid references of a point within the area of lands to which the application relates:

Land at Culvers Lane: TR 049194

Dengemarsh Farmland: TR 055210

Land at Horses Bones Farm: TR 033217

Land at New Romney: TR 067236

Warren Farm: TR 076257

Land Adjoining Rhee Wall: TR 024257

Land at Wenhams Lane: TR 029269

Land on the North East and South West Sides of Pickneybush Lane: TR 063284

Flaggsland: TR 035313

Lodgelands Farm: TR 038298

6. This deposit comprises the following statements and declarations:

Statement under section 31(6) of the Highways Act 1980

Statement under section 15A(1) of the Commons Act 2006.

PART B:
Statement under section 31(6) of the Highways Act 1980

We, Hugh Balcomb, Joan Patricia Balcomb, Alan Balcomb and Colin Balcomb are the owners of the land described in paragraph 4 of Part A of this form and shown red on the map accompanying this statement.

Ways shown green on the accompanying map are public bridleways.

Ways shown yellow on the accompanying map are public footpaths.

No other ways over the land shown red on the accompanying map have been dedicated as highways.

PART D:
Statement under section 15A(1) of the Commons Act 2006

We, Hugh Balcomb, Joan Patricia Balcomb, Alan Balcomb and Colin Balcomb are the owners of the land described in paragraph 4 of Part A of this form and shown coloured red on the map accompanying this statement.

We, Hugh Balcomb, Joan Patricia Balcomb, Alan Balcomb and Colin Balcomb wish to bring to an end any period during which persons may have indulged as of right in lawful sports and pastimes on the whole or any part of the land shown coloured red on the accompanying map.

PART E:
Additional information relevant to the application

In accordance with the Land Registry Title Plans and Registers, the land shown edged red on the attached plans is either owned entirely by Hugh Balcomb, or Hugh Balcomb and Joan Patricia Balcomb jointly. Other Titles are owned by Hugh Balcomb, Joan Patricia Balcomb, Alan Balcomb and Colin Balcomb jointly.

Norman Alfred Balcomb is also listed as a joint owner for one Title, although he is now deceased.

PART F:
Statement of Truth

WARNING: If you dishonestly enter information or make a statement that you know is, or might be, untrue or misleading, and intend by doing so to make a gain for yourself or another person, or to cause loss or the risk of loss to another person, you may commit the offence of fraud under section 1 of the Fraud Act 2006, the maximum penalty for which is 10 years' imprisonment or an unlimited fine, or both.

I BELIEVE THAT THE FACTS AND MATTERS CONTAINED IN THIS FORM ARE TRUE

Signature:

A black rectangular box redacting the signature.

Print full name:

Huatt BALCOMB.

Date: NOV 18th 2014

PART F:
Statement of Truth

WARNING: If you dishonestly enter information or make a statement that you know is, or might be, untrue or misleading, and intend by doing so to make a gain for yourself or another person, or to cause loss or the risk of loss to another person, you may commit the offence of fraud under section 1 of the Fraud Act 2006, the maximum penalty for which is 10 years' imprisonment or an unlimited fine, or both.

I BELIEVE THAT THE FACTS AND MATTERS CONTAINED IN THIS FORM ARE TRUE

Signature:

A black rectangular box redacting the signature.

Print full name:

JOAN PATRICIA BALCOMB.

Date: Nov 18th 2014

PART F:
Statement of Truth

WARNING: If you dishonestly enter information or make a statement that you know is, or might be, untrue or misleading, and intend by doing so to make a gain for yourself or another person, or to cause loss or the risk of loss to another person, you may commit the offence of fraud under section 1 of the Fraud Act 2006, the maximum penalty for which is 10 years' imprisonment or an unlimited fine, or both.

**I BELIEVE THAT THE FACTS AND MATTERS CONTAINED IN THIS FORM
ARE TRUE**

Signature:

A black rectangular box redacting the signature.

Print full name:

ALAN BALCOMB

Date:

18th Nov '14.

PART F:
Statement of Truth

WARNING: If you dishonestly enter information or make a statement that you know is, or might be, untrue or misleading, and intend by doing so to make a gain for yourself or another person, or to cause loss or the risk of loss to another person, you may commit the offence of fraud under section 1 of the Fraud Act 2006, the maximum penalty for which is 10 years' imprisonment or an unlimited fine, or both.

**I BELIEVE THAT THE FACTS AND MATTERS CONTAINED IN THIS FORM
ARE TRUE**

Signature:

A large black rectangular box redacting the signature.

Print full name:

COLIN BALECOMB

Date:

18/11/14

Land at Culvers Lane, Lydd

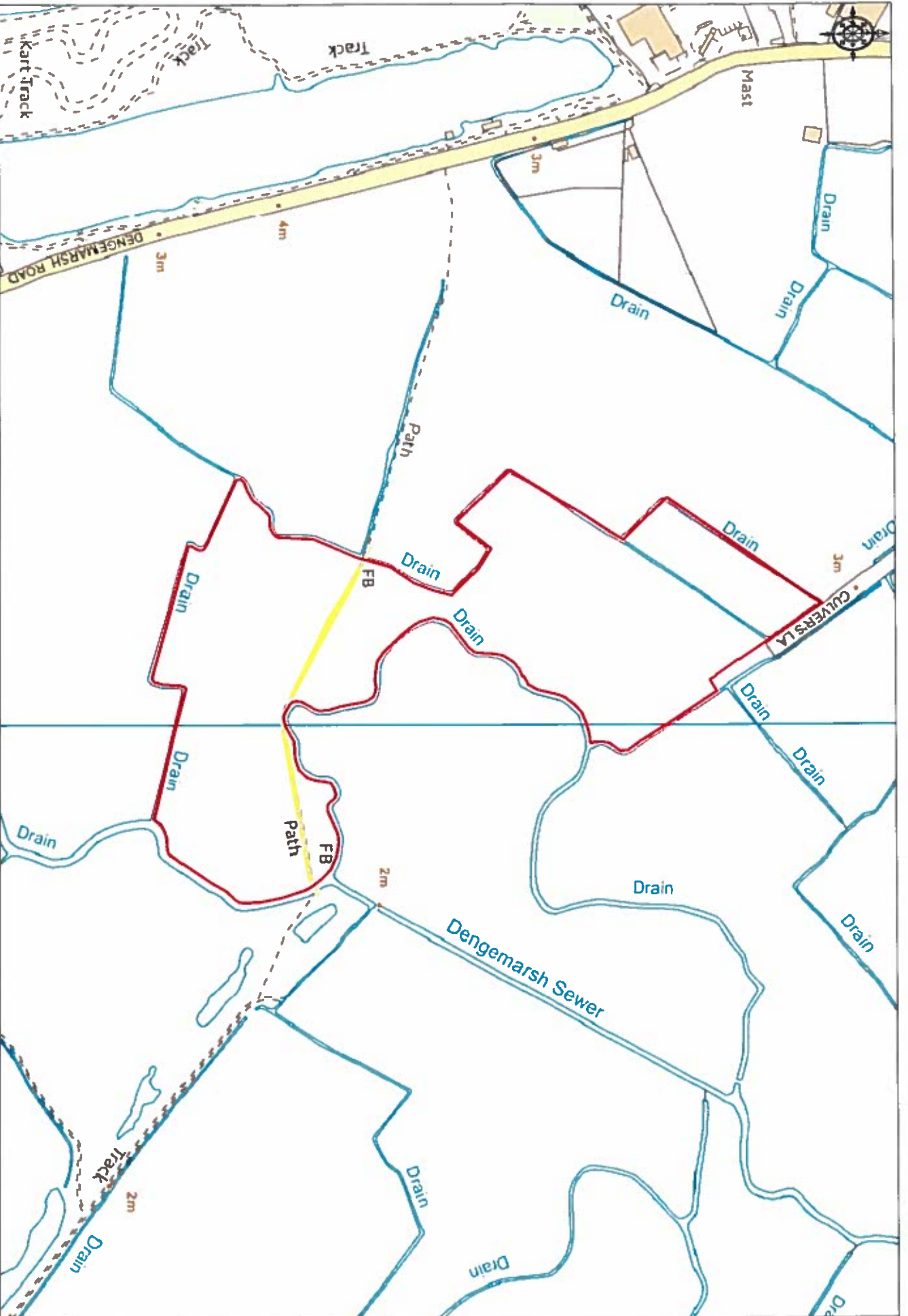

Dengemarsh Farmland, Lydd

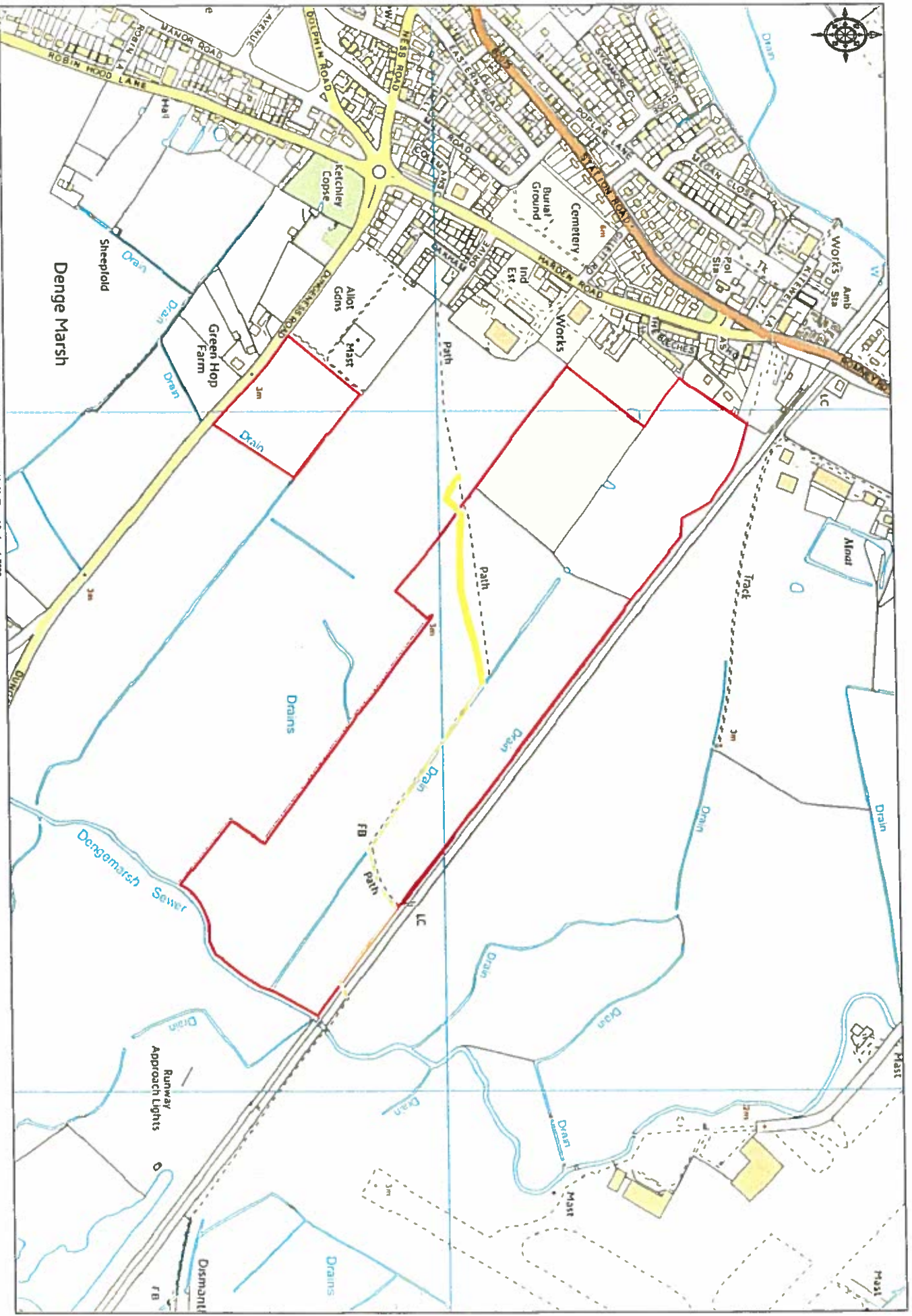

Land at Horses Bones Farm (Southern Part), Lydd, Romney Marsh, Kent, TN29 9PZ

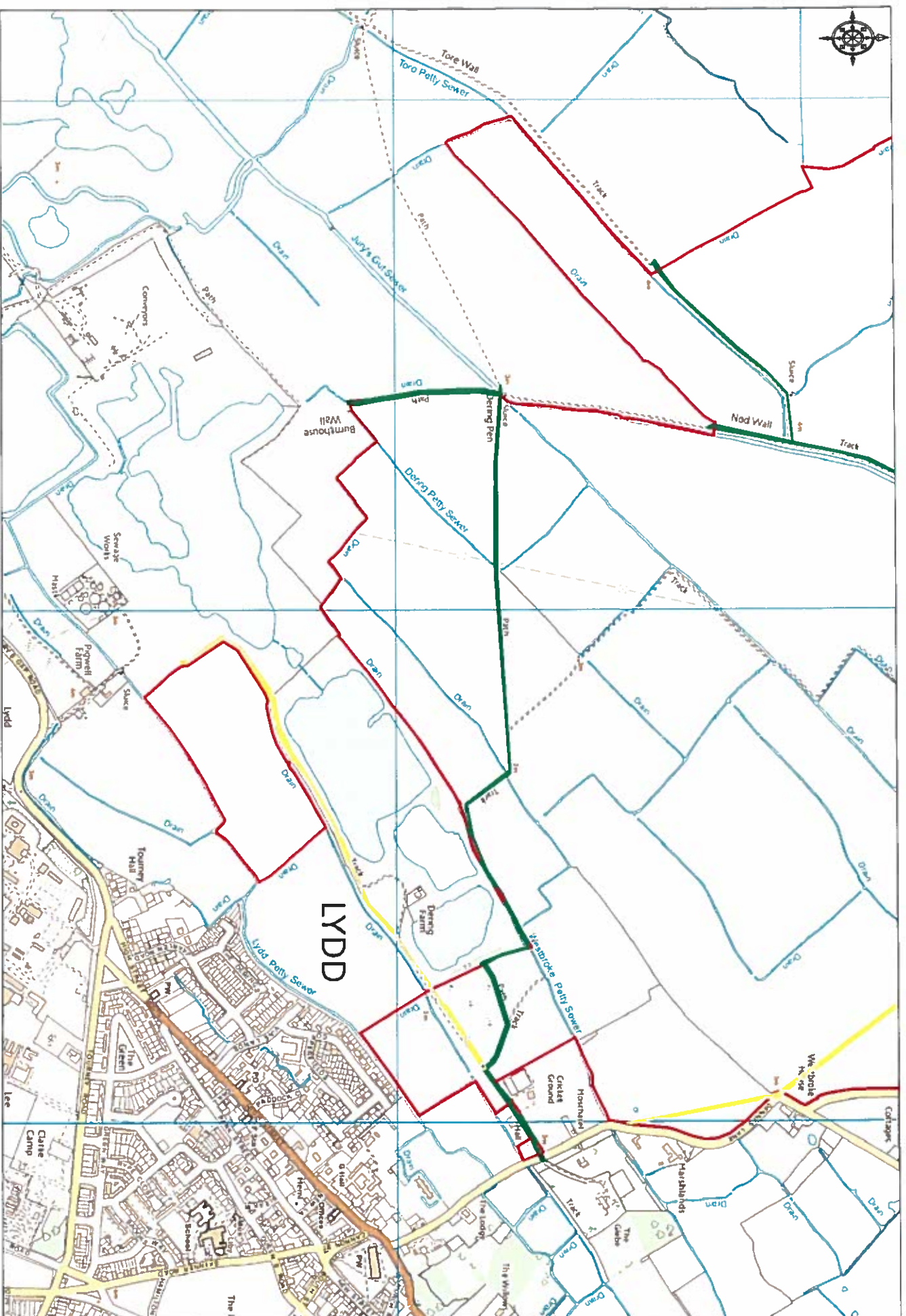

Land at Horses Bones Farm (Northern Part), Lydd, Romney Marsh, Kent, TN29 9PZ

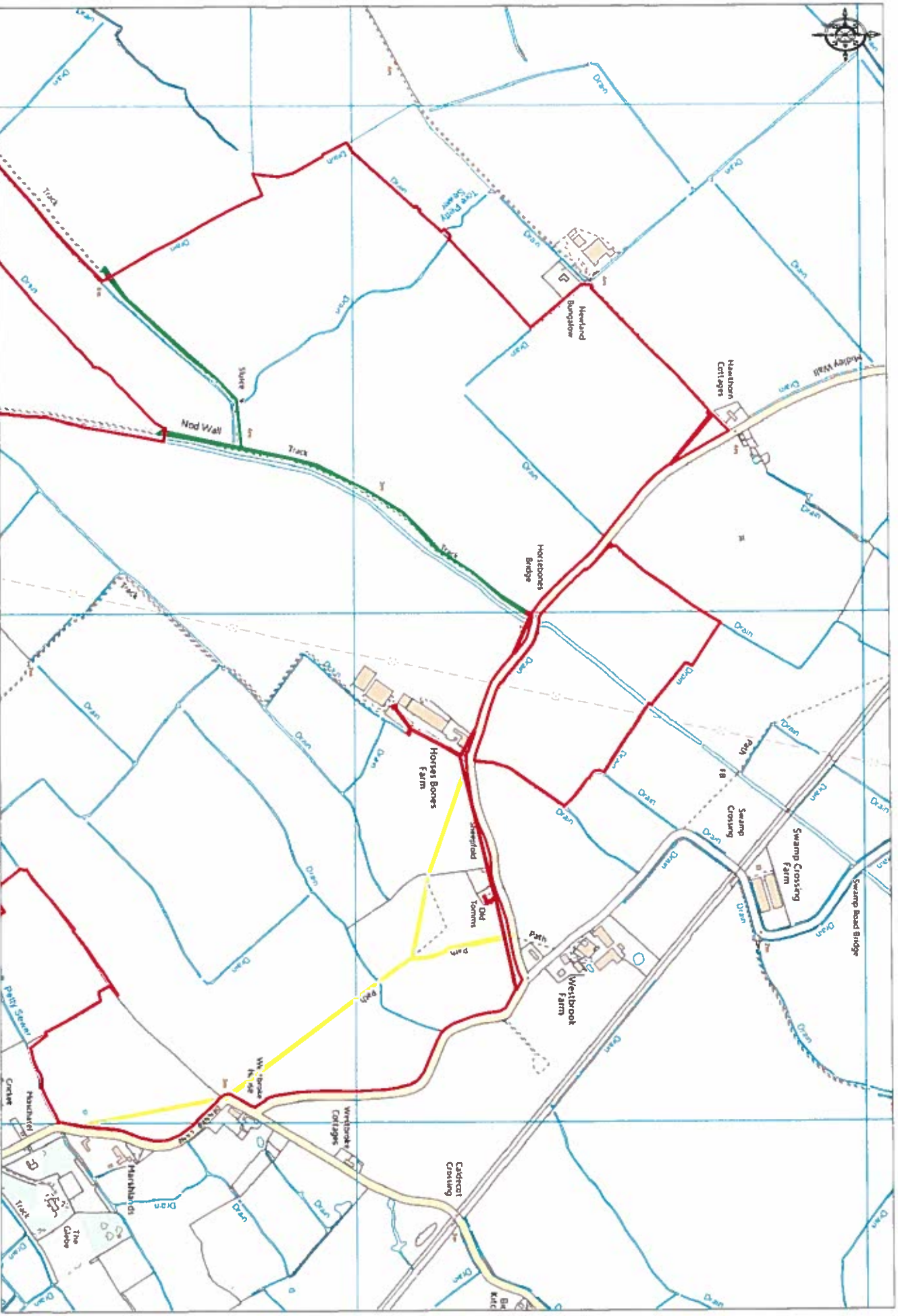

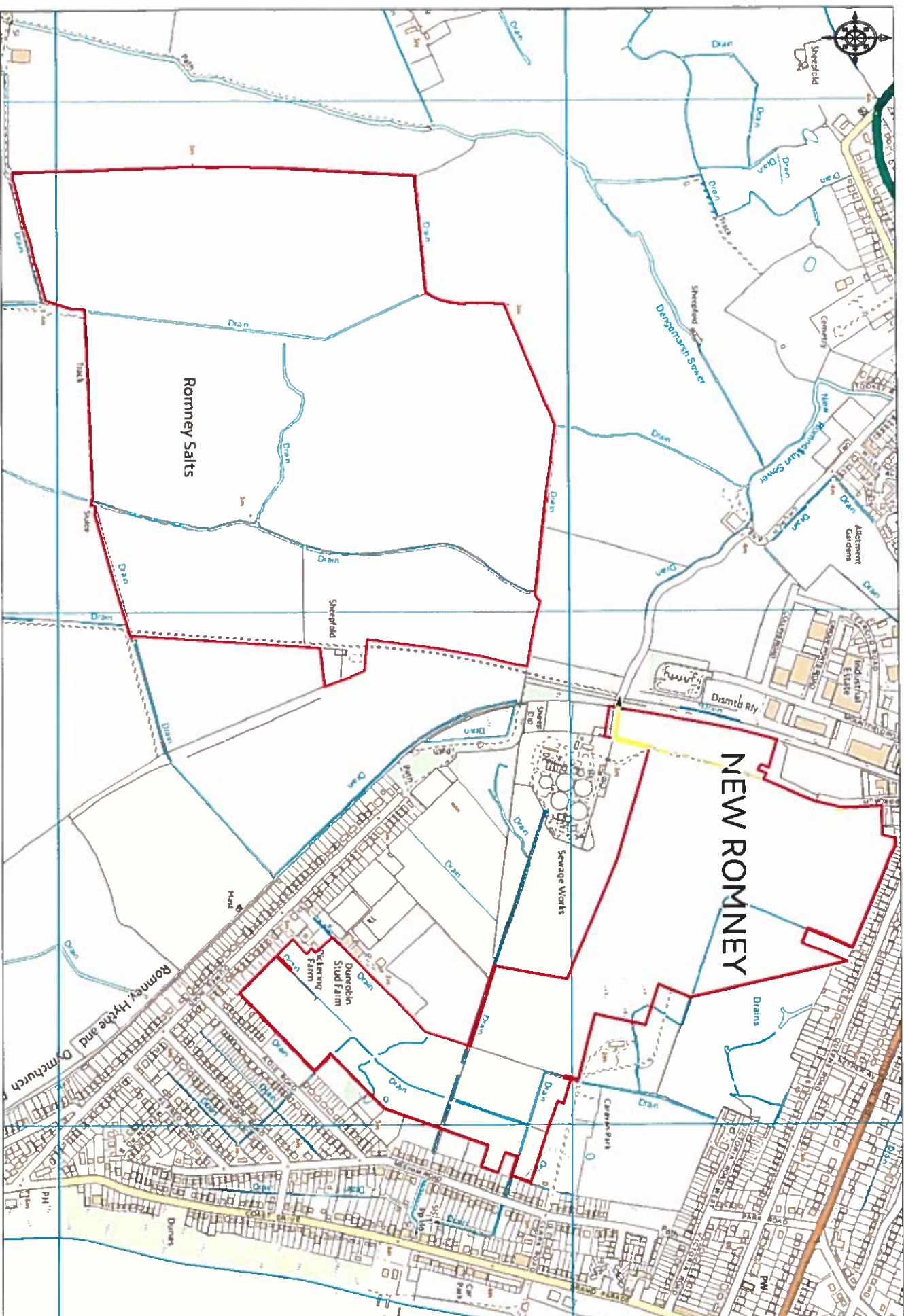

Warren Farm (Southern Part), Dymchurch Road, New Romney, TN28 8UE

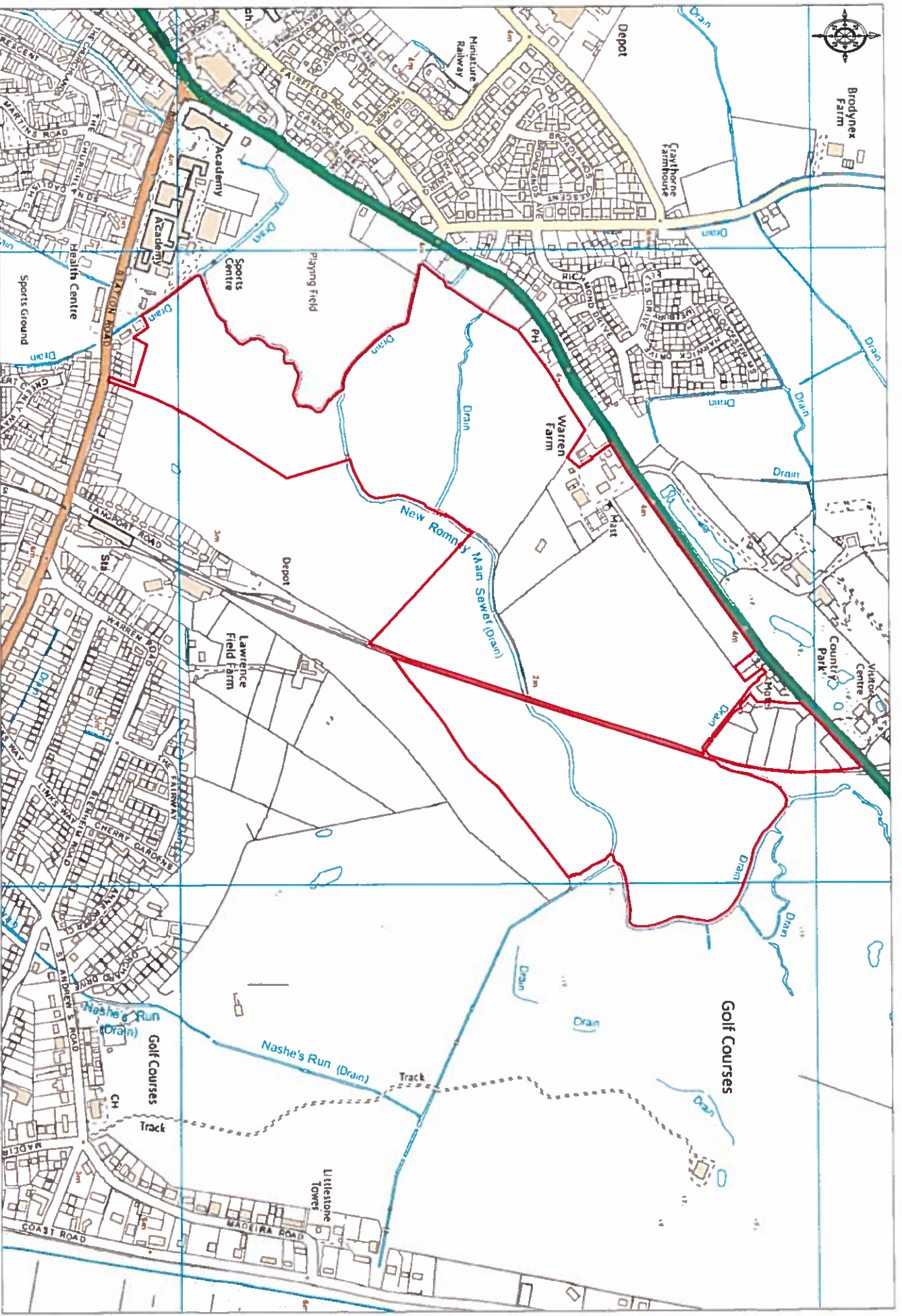

Warren Farm (Northern Part), Dymchurch Road, New Romney, TN28 8UE

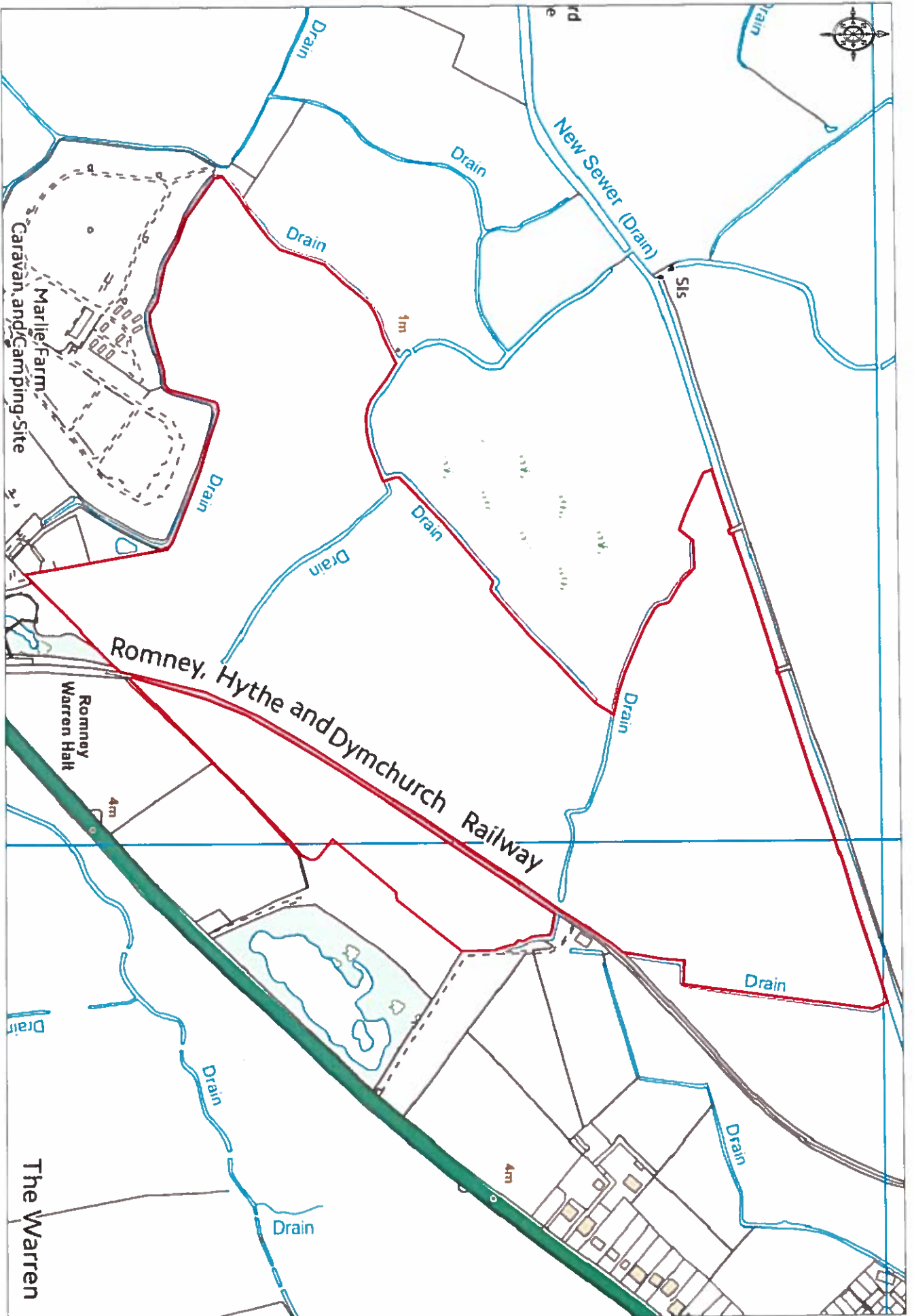

Land Adjoining Rhee Wall, Old Romney, Romney Marsh

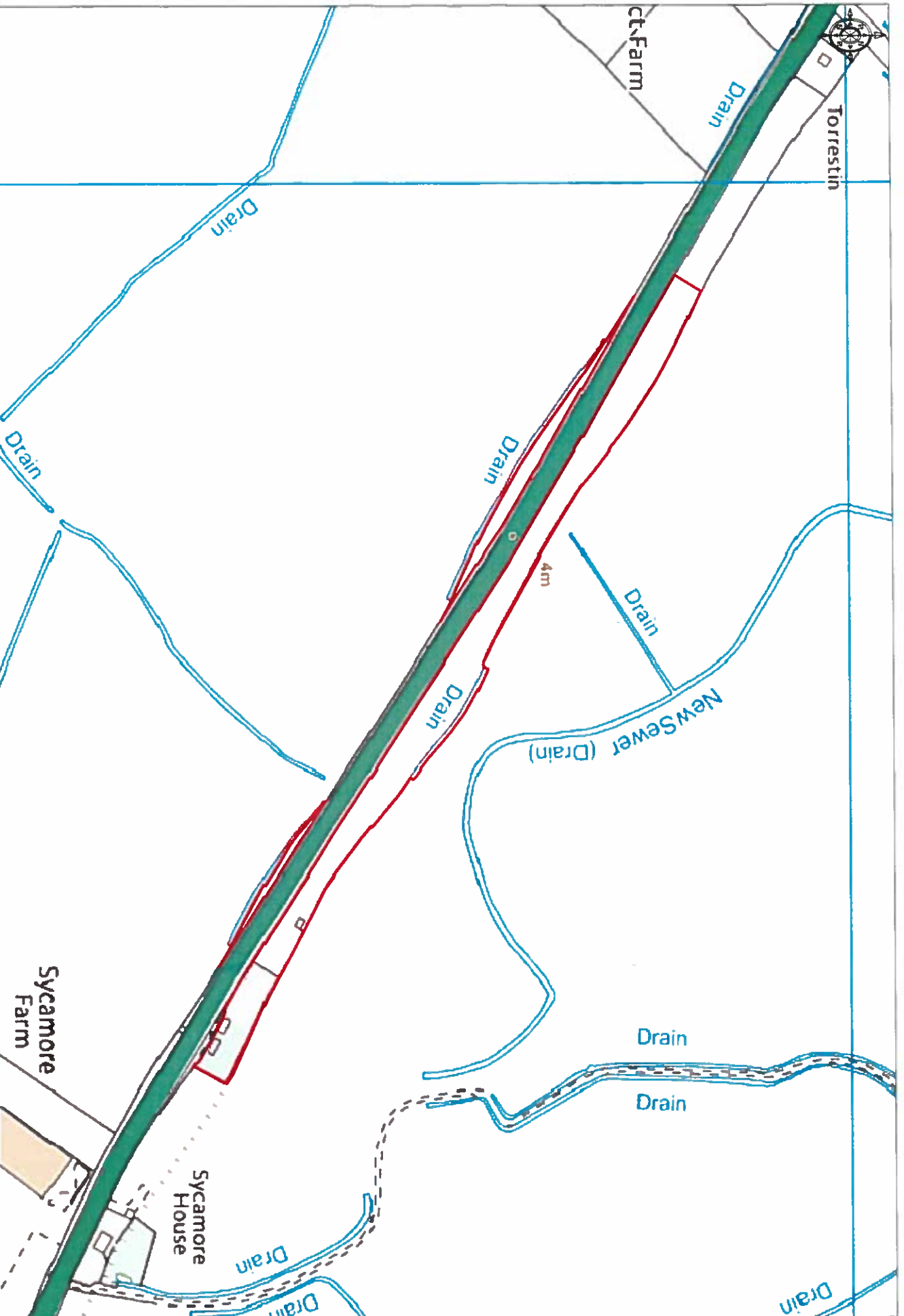

Land at Wenham's Lane, Iwychurch, Romney Marsh

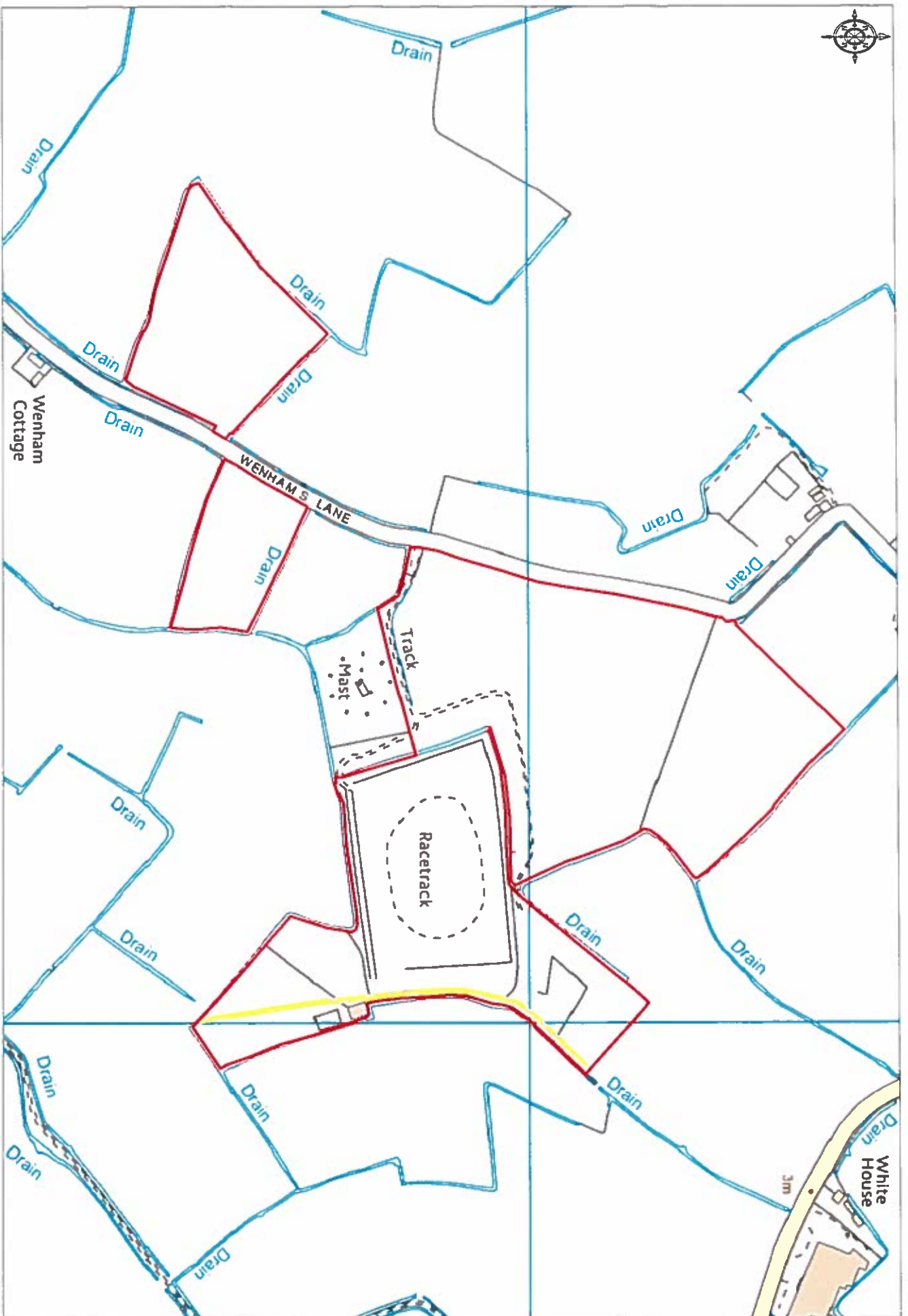

Land on the North East and South West Sides of Pickneybush Lane, St Mary in the Marsh, Romney

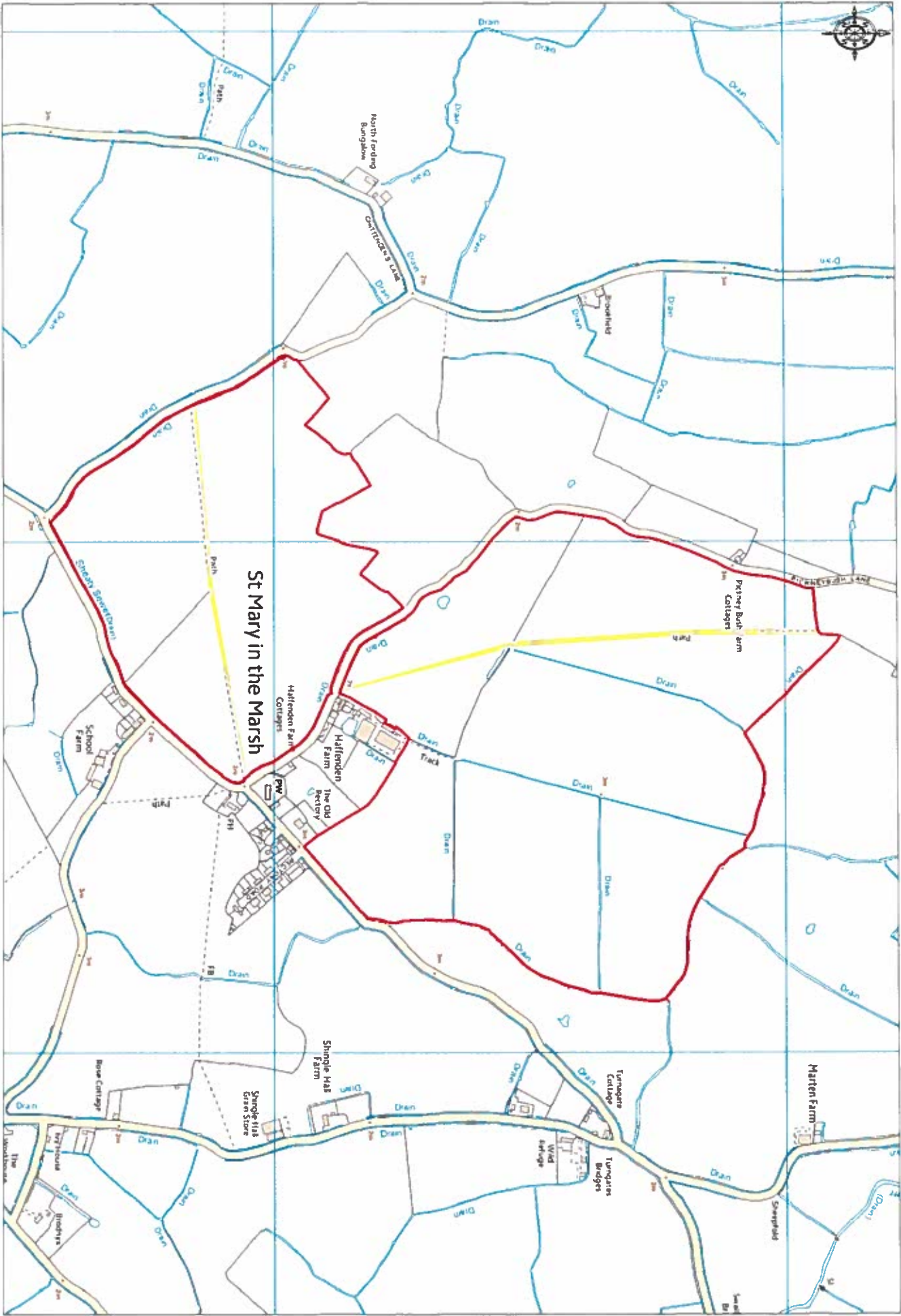

Ordnance Survey © Crown Copyright 2014. All rights reserved. Licence number 100023473. Printed Scale: 1:10000

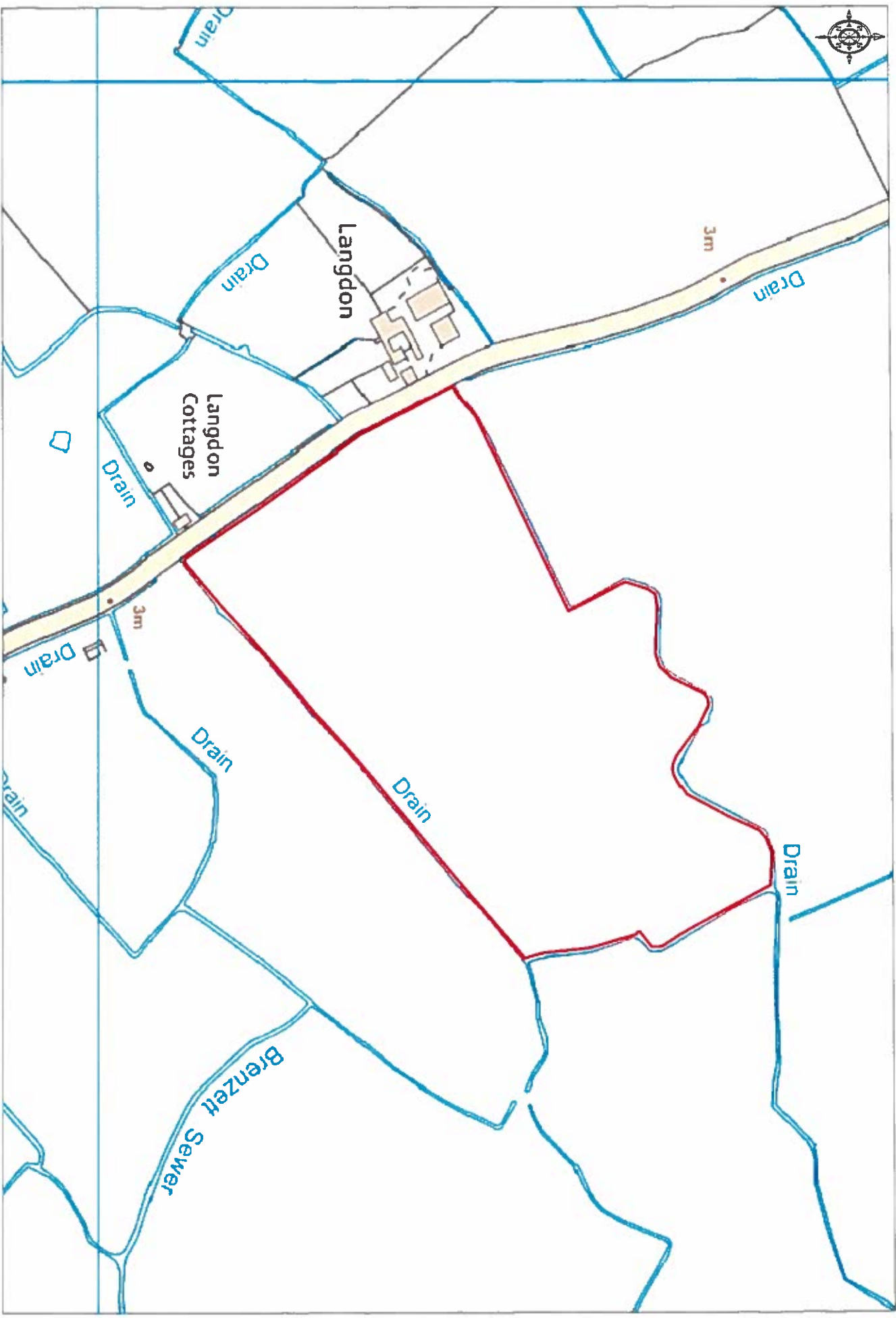

Lodgelands Farm, Newchurch Lane, Ruckinge, Ashford, TN26 2QE

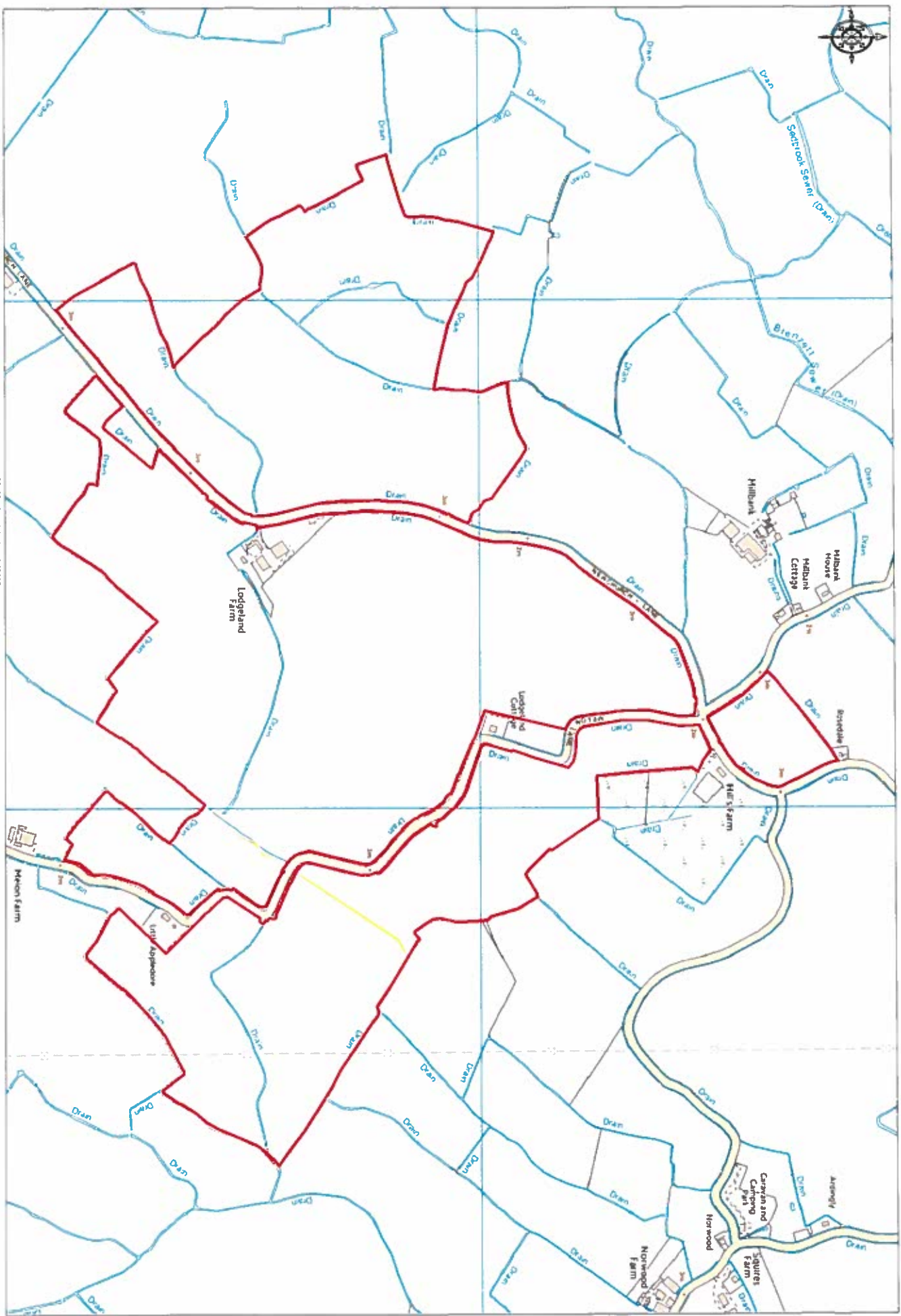

FORM CA16

PART A:

Information relating to the applicant and land to which the application relates

1. Name of appropriate authority to which the application is addressed:

Kent County Council.

2. Name and full address (including postcode) of applicant:

Mr Hugh Balcomb, Horses Bones Farm, Dennes Lane, Lydd, Romney Marsh, Kent, TN29 9PZ.

Mrs Joan Balcomb, Horses Bones Farm, Dennes Lane, Lydd, Romney Marsh, Kent, TN29 9PZ.

Mr Alan Balcomb, Horses Bones Farm, Dennes Lane, Lydd, Romney Marsh, Kent, TN29 9PZ.

Mr Colin Balcomb, Horses Bones Farm, Dennes Lane, Lydd, Romney Marsh, Kent, TN29 9PZ.

3. Status of applicant (tick relevant box or boxes):

I am

(a) ☒ the owner of the land(s) described in paragraph 4.

(b) ☐ making this application and the statements/declarations it contains on behalf of[insert name of owner] who is the owner of the land(s) described in paragraph 4 and in my capacity as [insert details]

4. Insert description of the lands to which the application relates (including full address and postcode):

Please see the attached plan.

Land at Culvers Lane, Lydd, TN29 9JE: One field parcel located south of the southern end of Culvers Lane.

Dengemarsh Farmland, Lydd, TN29 9JX: Two field parcels, located to the south of Lydd railway line and to the north of Dungeness Road.

Land at Horses Bones Farm, Lydd, TN29 9PZ: One large parcel of land surrounding Horses Bones Farm, Lydd, together with two smaller parcels located to the north of Lydd Petty Sewer. Another block lies to the north east of Midley Wall, Romney Marsh. As indicated on the plan, several small areas to the north of the main parcel have been divided from the main parcel due to the presence of easements.

Land at New Romney, TN28 8SW: Two blocks of land, located to the south east of Station Approach, and to the south of Church Lane.

Warren Farm, Dymchurch Road, New Romney, TN28 8UE: Two blocks of land located to the south east of the A259, divided by tracks and drainage ditches. A further parcel lies to the north of the A259, accessed via a track from a neighbouring caravan site.

Land Adjoining Rhee Wall, Old Romney, Romney Marsh, TN29 9SY: Three parcels of land on the north east and south west sides of the A259.

Land at Wenhams Lane, Ivychurch, Romney Marsh, TN29 0HS: Three parcels of land bordered partly by drainage ditches, located on the west and east of Wenhams Lane, Ivychurch.

Land on the North East and South West Sides of Pickneybush Lane, St Mary in the Marsh, Romney, TN29 0BY: Two large parcels of land, located to the east of Pickneybush Lane and to the east of Chittenden's Lane.

Flaggsland, Newchurch, Romney Marsh, TN26 2QA: Single parcel of land located on the opposite side of the road to Langdon Cottages, bordered mostly by drainage ditches.

Lodgelands Farm, Newchurch Lane, Ruckinge, Ashford, TN26 2QE: Three large parcels and one smaller parcel of land at Ruckinge. The smallest parcel is located to the north east of the junction between Newchurch Lane and Melon Lane. The easternmost parcel is located to the east of Melon lane. The largest parcel is located between Melon lane and Newchurch Lane, surrounding and including Lodgeland Farm. The westernmost parcel is located to the west of Newchurch Lane, opposite Lodgeland Farm, bordered mostly by drainage ditches.

5. Ordnance Survey six-figure grid references of a point within the area of lands to which the application relates:

Land at Culvers Lane: TR 049194

Dengemarsh Farmland: TR 055210

Land at Horses Bones Farm: TR 033217

Land at New Romney: TR 067236

Warren Farm: TR 076257

Land Adjoining Rhee Wall: TR 024257

Land at Wenhams Lane: TR 029269

Land on the North East and South West Sides of Pickneybush Lane: TR 063284

Flaggsland: TR 035313

Lodgelands Farm: TR 038298

6. This deposit comprises the following statements and declarations:

Statement under section 31(6) of the Highways Act 1980

Statement under section 15A(1) of the Commons Act 2006.

PART C:
Declaration under section 31(6) of the Highways Act 1980

1. We, Hugh Balcomb, Joan Patricia Balcomb, Alan Balcomb and Colin Balcomb are the owners of the land described in paragraph 4 of Part A of this form and shown red on the map lodged with Kent County Council on 21st January 2015.

2. On the 21st day of January 2015 we deposited with Kent County Council, being the appropriate council, a statement accompanied by a map showing our property [*red*] which stated that:

the ways shown green on that map had been dedicated as bridleways

the ways shown yellow on that map had been dedicated as footpaths

no other ways had been dedicated as highways over our property.

4. No additional ways have been dedicated over the land [*red*] on the map referenced in paragraph 1 above since the statement dated 21st January 2015 referred to in paragraph 2 above and at the present time we have no intention of dedicating any more public rights of way over our property.

PART F:
Statement of Truth

WARNING: If you dishonestly enter information or make a statement that you know is, or might be, untrue or misleading, and intend by doing so to make a gain for yourself or another person, or to cause loss or the risk of loss to another person, you may commit the offence of fraud under section 1 of the Fraud Act 2006, the maximum penalty for which is 10 years' imprisonment or an unlimited fine, or both.

I BELIEVE THAT THE FACTS AND MATTERS CONTAINED IN THIS FORM
ARE TRUE

Signature:

A black rectangular box redacting the signature.

Print full name:

HUGH BALCOMB.

Date:

6th Feb. '15.

PART F:
Statement of Truth

WARNING: If you dishonestly enter information or make a statement that you know is, or might be, untrue or misleading, and intend by doing so to make a gain for yourself or another person, or to cause loss or the risk of loss to another person, you may commit the offence of fraud under section 1 of the Fraud Act 2006, the maximum penalty for which is 10 years' imprisonment or an unlimited fine, or both.

I BELIEVE THAT THE FACTS AND MATTERS CONTAINED IN THIS FORM ARE TRUE

Signature

A black rectangular box redacting the signature.

Print full name:

JOAN PATRICIA BALCOWB

Date:

6/2/2015

PART F:
Statement of Truth

WARNING: If you dishonestly enter information or make a statement that you know is, or might be, untrue or misleading, and intend by doing so to make a gain for yourself or another person, or to cause loss or the risk of loss to another person, you may commit the offence of fraud under section 1 of the Fraud Act 2006, the maximum penalty for which is 10 years' imprisonment or an unlimited fine, or both.

I BELIEVE THAT THE FACTS AND MATTERS CONTAINED IN THIS FORM ARE TRUE

Signature:

A black rectangular box redacting the signature.

Print full name:

ALAN BALCOMB

Date:

6th FEB '15

PART F:
Statement of Truth

WARNING: If you dishonestly enter information or make a statement that you know is, or might be, untrue or misleading, and intend by doing so to make a gain for yourself or another person, or to cause loss or the risk of loss to another person, you may commit the offence of fraud under section 1 of the Fraud Act 2006, the maximum penalty for which is 10 years' imprisonment or an unlimited fine, or both.

I BELIEVE THAT THE FACTS AND MATTERS CONTAINED IN THIS FORM ARE TRUE

Signature:

A large black rectangular box redacting the signature.

Print full name:

COLIN BALCOMB

Date:

6 / 2 / 15