

Form CA17

Notice of landowner deposits under section 31(6) of the Highways Act 1980 and section 15A(1) of the Commons Act 2006

The Kent County Council

An application to deposit a map and statement under section 31(6) of the Highways Act 1980 and deposit a statement under section 15A(1) of the Commons Act 2006 has been made in relation to the land (or lands) described below and shown edged in red on the accompanying map.

PLEASE NOTE:

This deposit may affect rights over the land described below. Deposits made under section 31(6) of the Highways Act 1980 may prevent deemed dedication of public rights of way over such land under section 31(1) of that Act. Deposits made under section 15A(1) of the Commons Act 2006 may affect the ability to register such land as a town or village green under section 15 of that Act. Please see guidance at:

<http://www.defra.gov.uk/rural/protected/greens/> for further information.

Description of the land:

Land on the south side of Teddars Leas Road, Etchinghill, Folkestone, Kent, CT18 8DA

Name of the Parish, Ward or District in which the land is situated:

Etchinghill

The deposit was submitted by Ms Eileen Butcher, Greenacres, North Lyminge Lane, North Lyminge, Folkestone, Kent, CT18 8EF & Pentland Properties Limited, Etchinghill Golf Club, Etchinghill, Folkestone, Kent, CT18 7FA and was received by this authority on 18/11/2013.

The authority maintains a register of maps, statements and declarations deposited under section 31(6) of the Highways Act 1980 and section 15B of the Commons Act 2006.

This register can be accessed online at:

http://www.kent.gov.uk/environment_and_planning/countryside_access/definitive_map_and_statement/statutory_registers/deposits_registers.aspx

or can be inspected free of charge at the address below at the times indicated below: PROW & Access Service, Invicta House – 2nd Floor, County Hall, Maidstone, Kent, ME14 1XX Monday-Friday between the hours of 10.00am-4.00pm. It is advised that appointment is made beforehand by telephoning 03000 41 71 71.

Signed on behalf of **The Kent County Council:**

Name and Position of Signatory: Mike Overbeke,

Head of Regulatory Services



Date: 21st November 2013



Land Registry
Current title plan

Title number K869185
Ordnance Survey map reference TR1739SW
Scale 1:1250 enlarged from 1:2500
Administrative area Kent : Shepway



© Crown Copyright. Produced by Land Registry. Reproduction in whole or in part is prohibited without the prior written permission of Ordnance Survey. Licence Number 100026316.

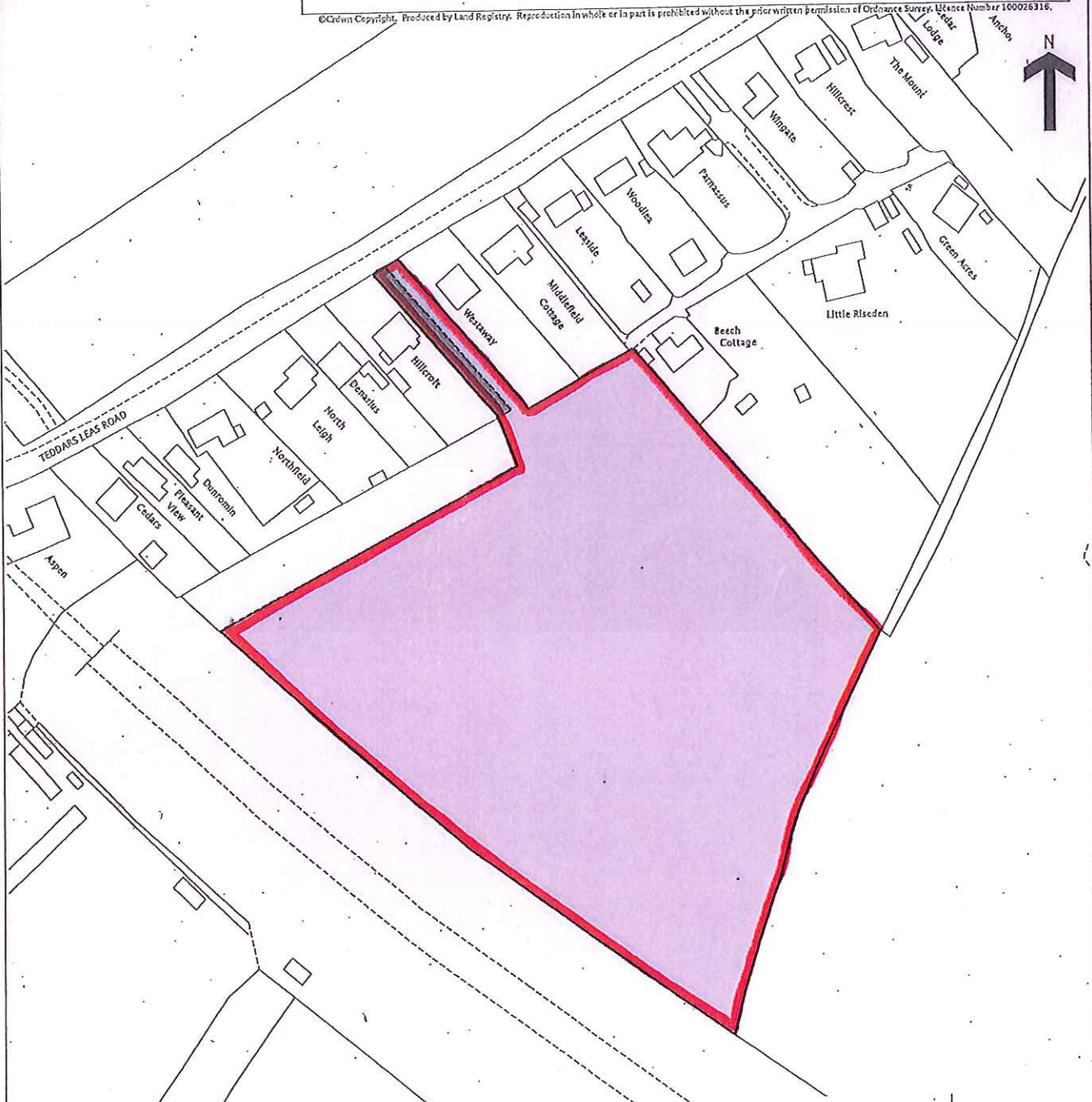

| | | | |
|--|---|--|--|
| Chartered Surveyors | Land on the south side of Teddars Leas Road Etchinghill Folkestone Kent | Scale: 1:1250 Date: October 2013 Revision: Drawn by: JMS Reference: 3051/06/P1 | |
| Reproduced from the Ordnance Survey Map with the permission of The Controller of Her Majesty's Stationery Office. © Crown Copyright Licence Number ES025698. Unauthorised publication infringes copyright. Published for the purposes of identification only and although believed to be correct its accuracy is not guaranteed. It is expressly excluded from any contract. | | | |
| G W FINN & SONS LLP 1-3 KING STREET SANDWICH KENT CT13 9BY 01304 612147 | | | |

This is a print of the view of the title plan obtained from Land Registry showing the state of the title plan on 01 October 2013 at 13:59:47. This title plan shows the general position, not the exact line, of the boundaries. It may be subject to distortions in scale. Measurements scaled from this plan may not match measurements between the same points on the ground. See Land Registry Public Guide 19 - Title plans and boundaries.

This title is dealt with by Land Registry, Nottingham Office.