

# Highway improvements in your area



## Proposed Cycle Route – Longport, Canterbury

---

### What we plan to do

Kent County Council are planning to install a cycle route between the city centre and the A257 St Martin's Hill. The first phase of the scheme will start in Longport between Monastery Street and Longport roundabout. Phase 2 will then continue towards Barton Court Grammar School with the construction of segregated cycle routes and improved crossing facilities. At the same time, works to improve the existing pelican crossing in Lower Bridge Street at the Burgate junction will get underway. It is hoped that by constructing phase 2 during the school summer holidays, delays will be kept to a minimum.

### When we plan to carry out the work and how long it will take

The work will take around **25 weeks** to complete, commencing on **2<sup>nd</sup> May 2023** between the hours of **7am and 6pm**.

### How will we carry out the works and how it will affect you?

Phase 1 of the works will be undertaken using **signing, coning and guarding only** to give our contractor a safe area within which to complete the necessary construction works whilst still maintaining two-way traffic flow. As works progress into phase 2, it will be necessary to use **temporary traffic signals** in St Martin's Hill. Fortunately, there is sufficient carriageway width in Lower Bridge Street to maintain two-way traffic flow with simple **signing, coning and guarding**.

For the carriageway resurfacing between Longport roundabout and North Holmes Road, it will be necessary to **close the road overnight** between the hours of **8pm and 6am** the day following for up to **10 nights** starting in **September 2023**. Signs will be erected on site giving the exact dates and times closer to the event. The signed diversion will be via Wingham and the A2, however local unsigned routes are expected to be utilised during this time.

### Why are we doing this work?

There is currently a busy pedestrian and cycle desire line from the residential areas to access the city centre, schools and colleges as well as local and high street shops. This will increase over time with the progression of new housing in the area.

### How you can help us

We need your help to make sure the work is completed as quickly as possible and to the best quality, without causing you too much inconvenience.

***For your safety and the safety of our workforce, please drive carefully and slowly through the roadworks.***

Feedback from our workers shows that too many drivers go too fast through roadworks. Everyone is entitled to a safe workplace and our staff work next to moving traffic and risk injury every day to maintain and improve the highway for everyone.

### How to contact us?

For further information or to find out more about what we do please visit our website [www.kent.gov.uk/highways](http://www.kent.gov.uk/highways) where you can also report a fault on any of our roads across Kent. You can find us on Twitter @KentHighways. You can also view our diversion/permit details at [www.one.network](http://www.one.network). Alternatively, you can call us on **03000 41 81 81**.

We often ask residents to fill in a short feedback survey online at [www.kent.gov.uk/roadworkssurvey](http://www.kent.gov.uk/roadworkssurvey).

### WARNING – Beware Bogus Callers

Kent County Council Highways, Transportation and Waste do not allow works to be carried out on private properties. If anyone says they are working for us or our specialist contractors and offer to carry out any work for cash, they should be treated with caution. We advise you to contact Citizen's Advice on 03444 111 444 (Monday to Friday 9.00am to 5.00p)

# Highway improvements in your area



## Proposed Cycle Route – Longport, Canterbury

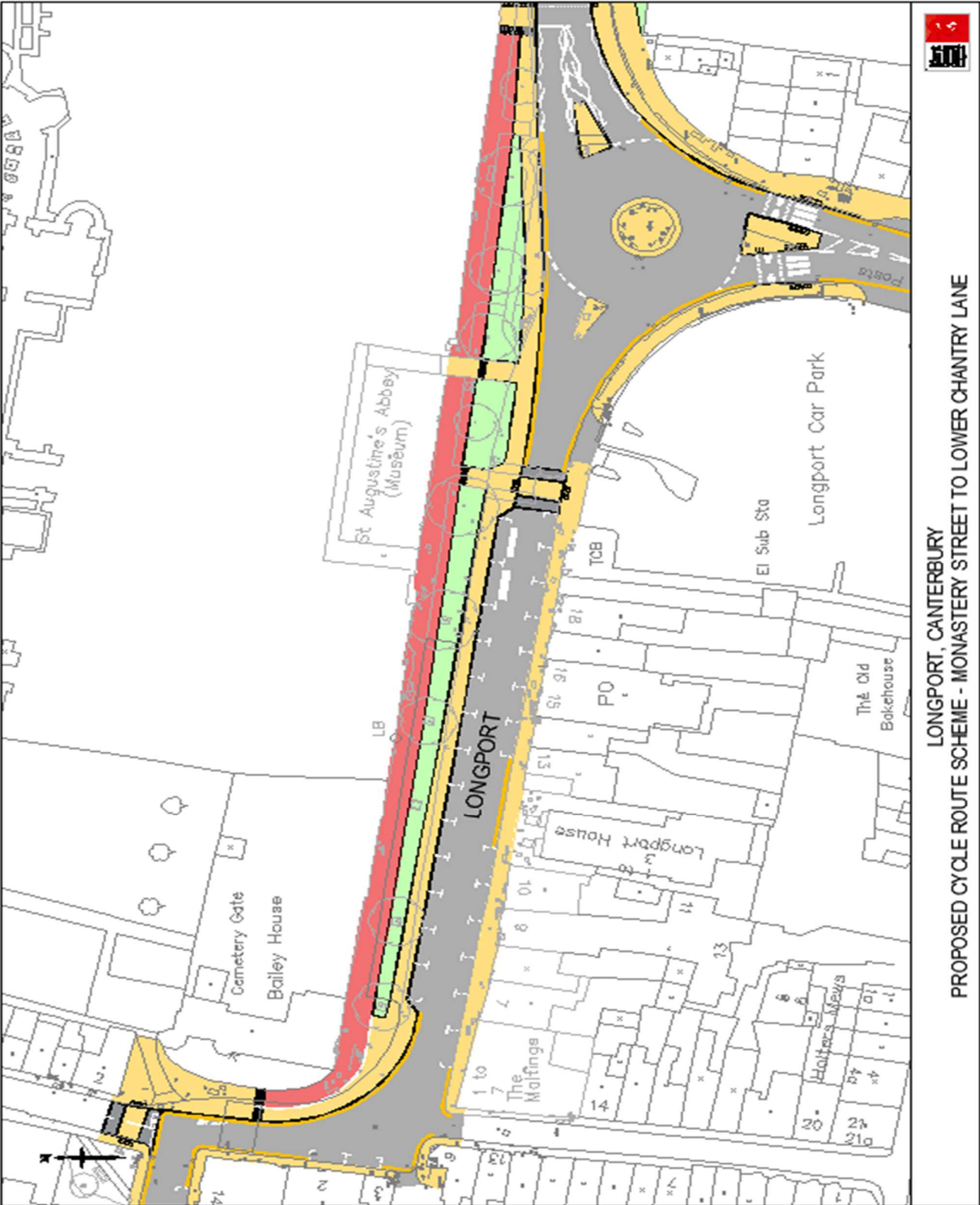

LONGPORT, CANTERBURY  
PROPOSED CYCLE ROUTE SCHEME - MONASTERY STREET TO LOWER CHANTRY LANE