

Form CA17

Notice of landowner deposits under section 31(6) of the Highways Act 1980 and section 15A(1) of the Commons Act 2006

The Kent County Council

An application to deposit a map and statement and subsequently lodge a declaration under section 31(6) of the Highways Act 1980 has been made in relation to the land (or lands) described below and shown hatched and edged brown on the accompanying map.

PLEASE NOTE:

This deposit may affect rights over the land described below. Deposits made under section 31(6) of the Highways Act 1980 may prevent deemed dedication of public rights of way over such land under section 31(1) of that Act. Deposits made under section 15A(1) of the Commons Act 2006 may affect the ability to register such land as a town or village green under section 15 of that Act. Please see guidance at:

<http://www.defra.gov.uk/rural/protected/greens/> for further information.

Description of the lands:

Land at and surrounding Morry Farm, Morry Lane, East Sutton, Maidstone, Kent, ME17 3DR.

Name of the Parish, Ward or District in which the lands are situated:

East Sutton and Ulcombe, Maidstone

The deposit was submitted by Mr Graham Edmed and was received by this authority on 20/01/2014. The declaration was made on 12/02/2014.

The authority maintains a register of maps, statements and declarations deposited under section 31(6) of the Highways Act 1980 and section 15B of the Commons Act 2006.

This register can be accessed online at:

http://www.kent.gov.uk/environment_and_planning/countryside_access/definitive_map_and_statement/statutory_registers/deposits_registers.aspx

or can be inspected free of charge at the address below at the times indicated below: PROW & Access Service, Invicta House – 2nd Floor, County Hall, Maidstone, Kent, ME14 1XX Monday-Friday between the hours of 10.00am-4.00pm. It is advised that appointment is made beforehand by telephoning 03000 41 71 71.

Signed on behalf of **The Kent County Council**:

Name and Position of Signatory: Mike Overbeke,

Head of Regulatory Services



Date: 3rd March 2014



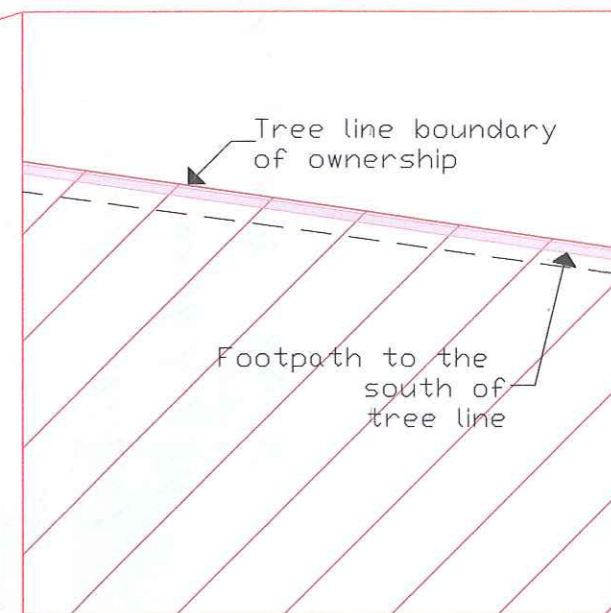

Detail

Scale 1 : 1,250 @ A3

(c) Crown Copyright 2013
Reproduction in whole or in part is prohibited
without the prior permission of Ordnance Survey.

Scale 1 : 5,000 @ A3



- Footpath
- Bridleway
- Restricted byway
- Byway
- Path closed or use restricted

Area of ownership covered
by this definitive statement.

- Stile
- Step(s)
- Gate
- Bridge

Land owned by.
Mr G A Edmed
Morry Farm,
Morry Lane,
East Sutton,
Maidstone.
Kent. ME17 3DR

Map GAE-002-12/11/13
Prepared 12/11/2013

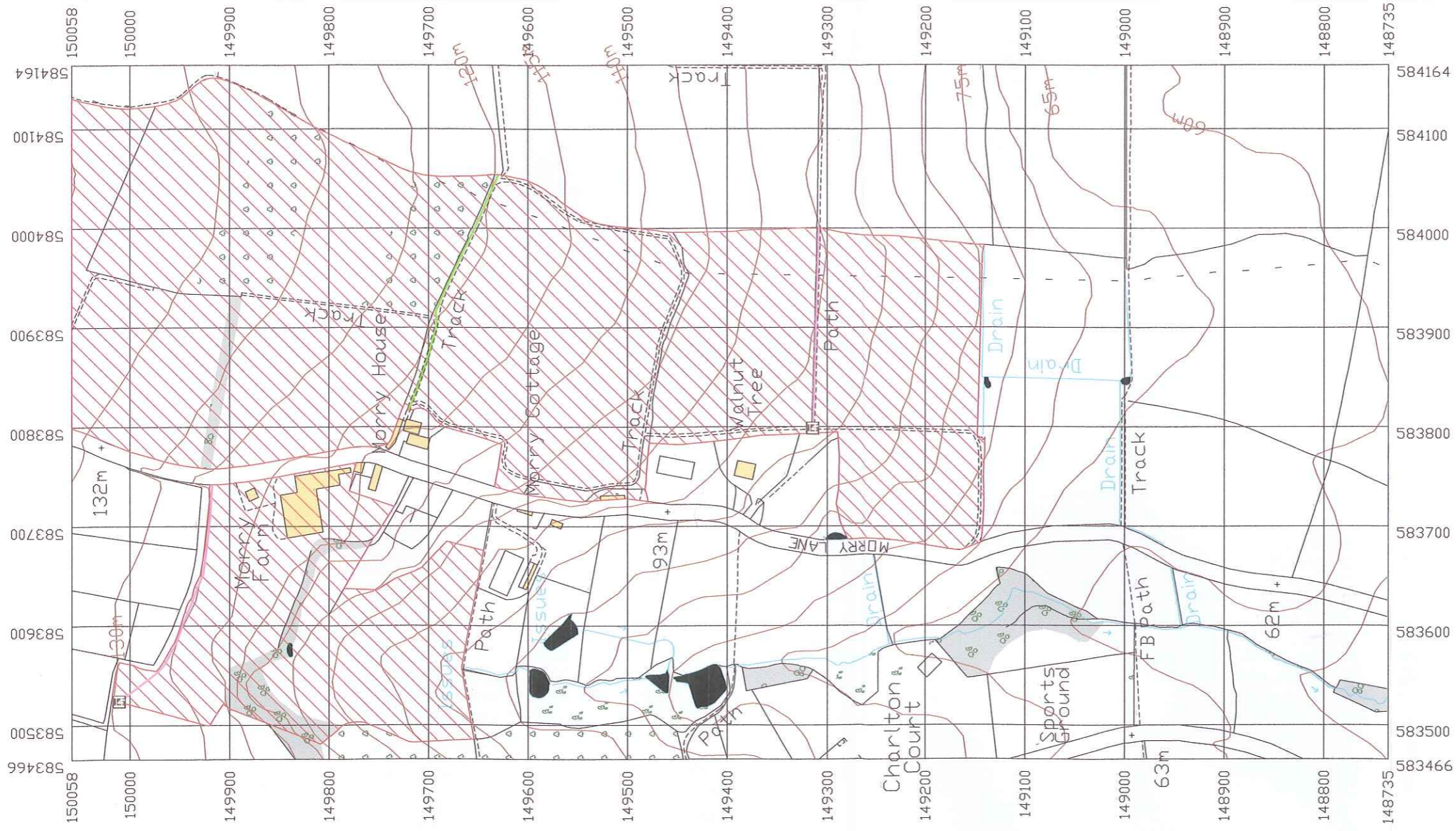

(c) Crown Copyright 2013
 Reproduction in whole or in part is prohibited
 without the prior permission of Ordnance Survey.

Scale 1 : 5,000 @ A3

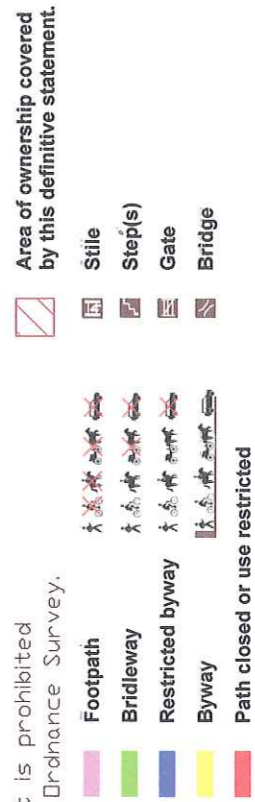
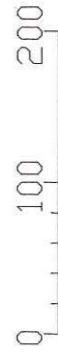

Land owned by.
 Mr G A Edmed
 Morry Farm,
 Morry Lane,
 East Sutton,
 Maidstone.
 Kent. ME17 3DR

Map GAE-001-12/11/13
 Prepared 12/11/2013