



## Project Update - January 2026

Many people will be aware of the proposal to improve the junction of the B2017 Badsell Road and B2160 Maidstone Road which is needed to reduce the traffic impacts of three major housing sites in Paddock Wood. The developers were required to jointly fund infrastructure improvements in Paddock Wood, which included this junction. The developer adjacent to Badsell Road was also required to make land available from their site for the improvement.

As three developers were involved, the County Council agreed to take the lead and deliver the improvement for a local

realignment of Badsell Road leading to a crossroads junction with Mascalls Court Road.

However, changes in how the Environment Agency assess flood risk has made it impossible to deliver the original concept scheme within the land available. There are existing watercourses entering into an underground culvert that then follows the alignment of Maidstone Road and continues into the centre of Paddock Wood. This culvert forms a constraint on the drainage network meaning that the area is prone to occasional flooding during extreme weather events and it's important that this flooding risk does not increase. After considerable flood modelling and a review of all available options, the amended scheme shown on the plan overleaf has been approved to be taken forward.

The widening of Badsell Road has had to be kept closer to the existing road to minimise the amount of extra impermeable (i.e. non-absorbent) hard surface and it retains the current staggered junction with Mascalls Court Road. The junction with Maidstone Road will remain as a signal controlled junction but with an additional lane being provided on Badsell Road to increase capacity on that approach. The junction of Maidstone Road and Mascalls Court Road will remain as a give way, priority junction. The scheme delivers capacity improvements, provides additional footway/cycleway links to the new housing development and improved crossing facilities for pedestrians and cyclists comparable to the original concept scheme.

The revised layout also maximises the land available on the upstream side of Badsell Road for drainage lagoons and an underground storage area for surface water which will reduce flood risk during heavy rain. Holding back water in times of heavy rainfall allows discharge flows to be



*The Badsell Road junction*

# Badsell Road, Paddock Wood Junction Improvement



slowed and ensures that the culvert that runs under the junction can cope and help reduce the risk of flooding within the immediate site area and more widely in Paddock Wood.

The disadvantage of the amended scheme is that it will leave traffic close to two houses on Badsell Road and requires the removal of several mature trees on the land opposite, but unfortunately this is unavoidable. Space is very limited but some landscaping will be provided where possible to help offset the loss of the trees.

The scheme does not require planning permission and can proceed as Permitted Development. The detailed design is complete and final technical submissions are with the Environment Agency for approval for the extension of the culvert beneath Maidstone Road.

Construction tenders have been invited and subject to satisfactory returns it is anticipated that a contract award will be made in April 2026. Construction would then start in June 2026 and it is expected that the scheme would be substantially completed by the end of December 2026. Advance site clearance will take place in early spring 2026.

## Upcoming Works—Trial Holes to Locate Utility Apparatus

We will be undertaking some trial holes to establish the depth and location of utility apparatus to confirm if they will be affected by the scheme. They are located at the junction of Badsell Road/Maidstone Road and at the junction of Badsell Road and Mascalls Park.

To reduce the impact of the work at this busy junction, the trial holes are programmed to be carried out this coming weekend with the ones at the Badsell Road/Maidstone Road junction being carried out on **Saturday 10 January** between approximately 8am and 4pm and at the Badsell Road/Mascalls Park junction on **Sunday 11 January**, between approximately 9am and 4pm.

The trial holes on Saturday will require the existing signals to be switched off and the junction controlled by 3-way temporary signals. On Sunday, temporary 2-way signals will be required on Badsell Road, which will be manually controlled to co-ordinate with the junction signals.

There are also trial holes to undertake within the land to the south of Badsell Road and it is hoped that these can also be completed at the weekend but if this is not possible our contractor will return to complete these at a later date but they are off the road and will not require any traffic management.

We ask for your patience and co-operation whilst these works are undertaken.

## How to Contact Us

A further update will be issued in the spring when we are clearer about the construction timetable but in the meantime if you have any queries or would like more information about the project please call us on **03000 418181** (Monday to Friday 9am to 5pm) or contact us via the project email address at [badsellroad@kent.gov.uk](mailto:badsellroad@kent.gov.uk).

# B2017 BADSELL ROAD/B2160 MAIDSTONE ROAD - JUNCTION IMPROVEMENT

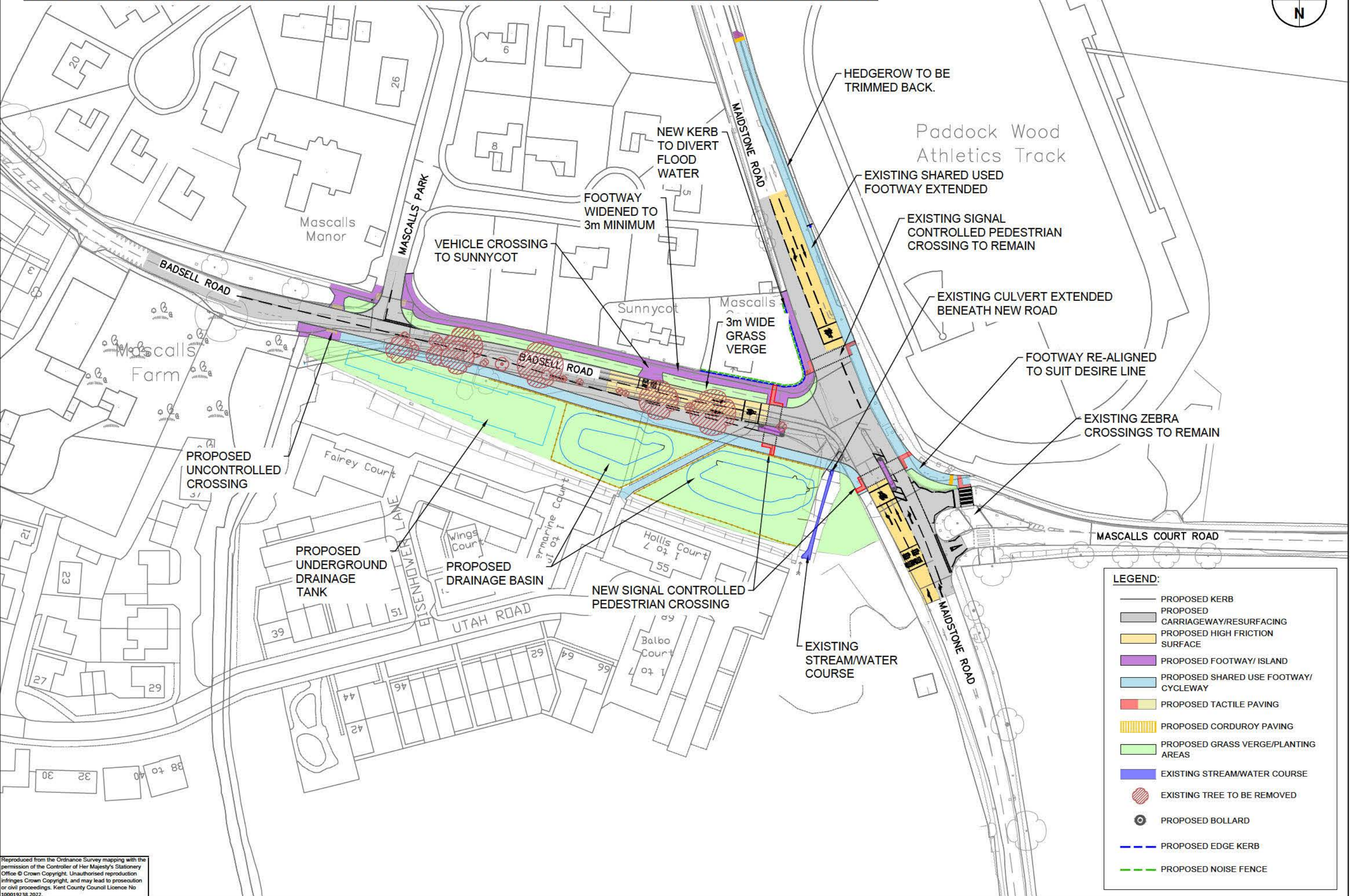
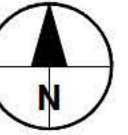

HEDGEROW TO BE TRIMMED BACK.

Paddock Wood Athletics Track

NEW KERB TO DIVERT FLOOD WATER

EXISTING SHARED USED FOOTWAY EXTENDED

FOOTWAY WIDENED TO 3m MINIMUM

EXISTING SIGNAL CONTROLLED PEDESTRIAN CROSSING TO REMAIN

VEHICLE CROSSING TO SUNNYCOT

EXISTING CULVERT EXTENDED BENEATH NEW ROAD

Mascalls 3m WIDE GRASS VERGE

FOOTWAY RE-ALIGNED TO SUIT DESIRE LINE

EXISTING ZEBRA CROSSINGS TO REMAIN

PROPOSED UNCONTROLLED CROSSING

PROPOSED UNDERGROUND DRAINAGE TANK

PROPOSED DRAINAGE BASIN

NEW SIGNAL CONTROLLED PEDESTRIAN CROSSING

EXISTING STREAM/WATER COURSE

**LEGEND:**

- PROPOSED KERB
- PROPOSED CARRIAGEWAY/RESURFACING
- PROPOSED HIGH FRICTION SURFACE
- PROPOSED FOOTWAY/ ISLAND
- PROPOSED SHARED USE FOOTWAY/ CYCLEWAY
- PROPOSED TACTILE PAVING
- PROPOSED CORDUROY PAVING
- PROPOSED GRASS VERGE/PLANTING AREAS
- EXISTING STREAM/WATER COURSE
- EXISTING TREE TO BE REMOVED
- PROPOSED BOLLARD
- PROPOSED EDGE KERB
- PROPOSED NOISE FENCE

Reproduced from the Ordnance Survey mapping with the permission of the Controller of Her Majesty's Stationery Office © Crown Copyright. Unauthorised reproduction infringes Crown Copyright, and may lead to prosecution or civil proceedings. Kent County Council Licence No 100019238.2022.