

B2017 BADSELL ROAD/B2160 MAIDSTONE ROAD - JUNCTION IMPROVEMENT

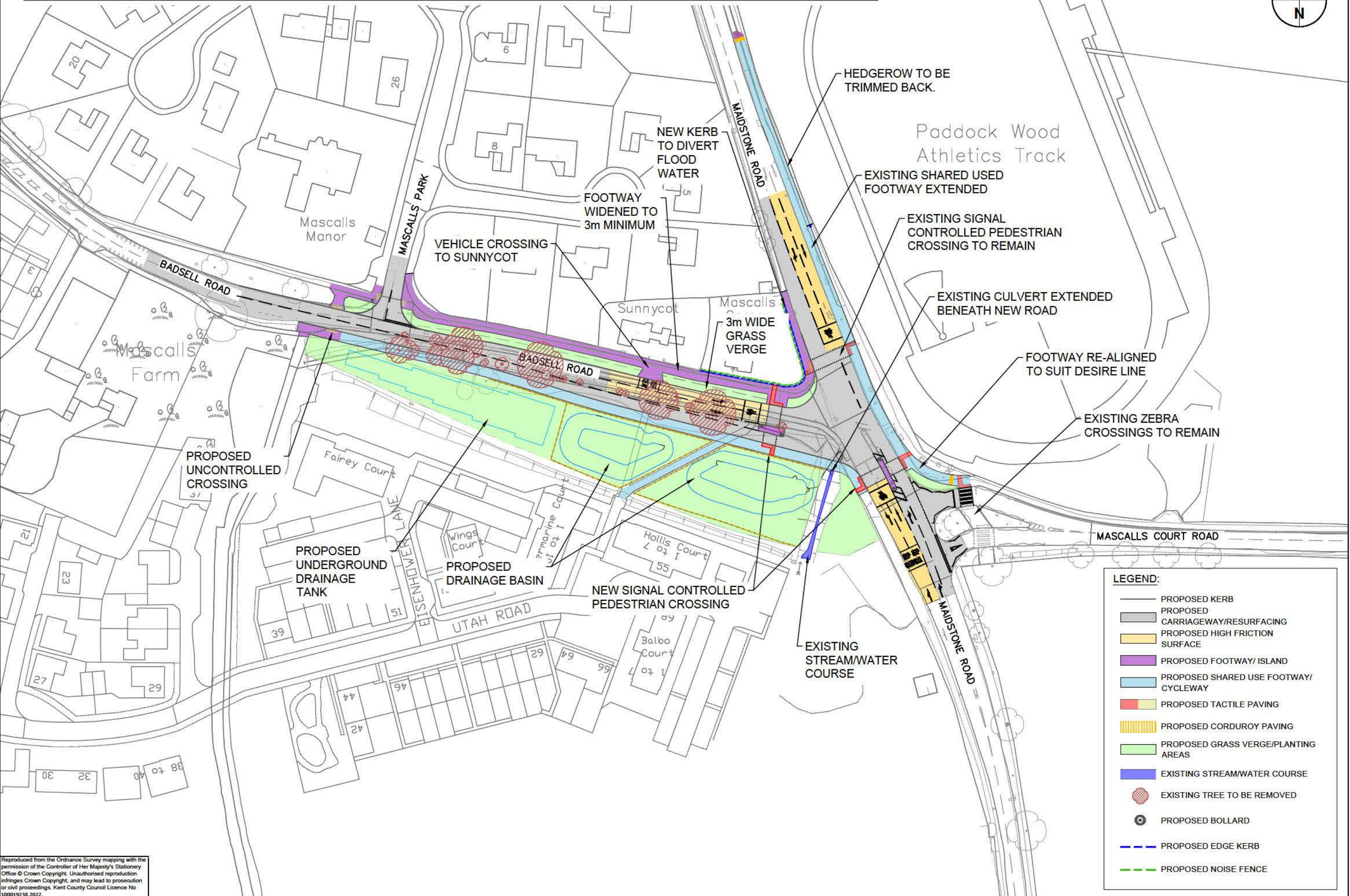

- LEGEND:**
- PROPOSED KERB
 - ▒ PROPOSED CARRIAGEWAY/RESURFACING
 - ▒ PROPOSED HIGH FRICTION SURFACE
 - ▒ PROPOSED FOOTWAY/ ISLAND
 - ▒ PROPOSED SHARED USE FOOTWAY/ CYCLEWAY
 - ▒ PROPOSED TACTILE PAVING
 - ▒ PROPOSED CORDUROY PAVING
 - ▒ PROPOSED GRASS VERGE/PLANTING AREAS
 - ▒ EXISTING STREAM/WATER COURSE
 - ⊙ EXISTING TREE TO BE REMOVED
 - ⊙ PROPOSED BOLLARD
 - ▒▒▒ PROPOSED EDGE KERB
 - ▒▒▒ PROPOSED NOISE FENCE

Reproduced from the Ordnance Survey mapping with the permission of the Controller of Her Majesty's Stationery Office © Crown Copyright. Unauthorised reproduction infringes Crown Copyright, and may lead to prosecution or civil proceedings. Kent County Council Licence No 100019238.2022.