

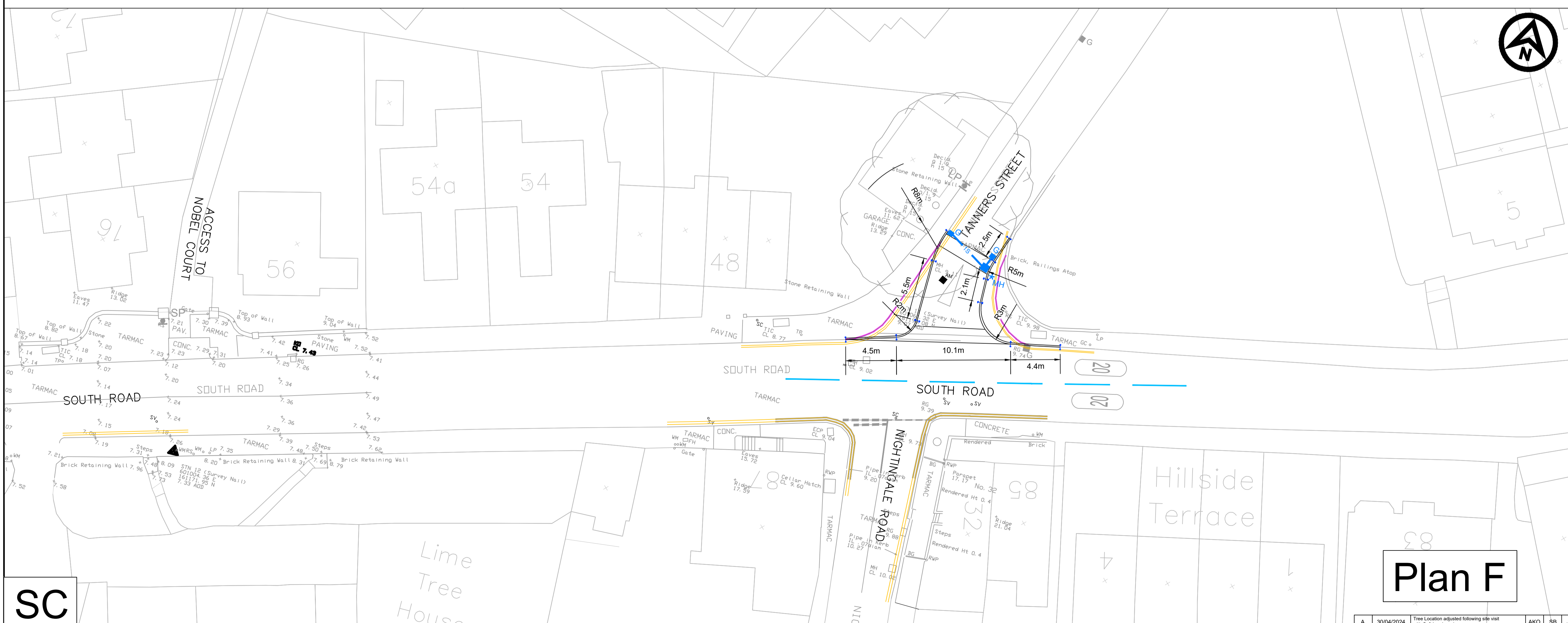

GA

Plan F



SC

Plan F

- Notes**
- Please see notes cover sheet which applies to all drawings
- Kerbing / Footway / Carriageway Construction Key**
- Overlay footway with ACB dense surf 100/150 20mm thick over AC10 regulating layer. Perimeter of surface course to be keyed into existing surface course to give a minimum layer thickness of 20mm. All joints to be saw cut.
  - See design drawing for details
  - New grass seeding laid on a layer of top soil and Type 1 base. All joints to be saw cut
  - HB2 Proposed 125 x 255mm half battered kerbing (Type HB2). "Haunch/Variation B" upstand 125mm to KCC/1100/001/D.
  - DK Proposed 125 x 150mm bullnose kerbing (Type BN). Upstand 0-6mm to KCC/1100/001/D.
  - TK Proposed 125 x 150mm bullnose kerbing (Type BN). Upstand 25mm to KCC/1100/001/D.
  - D Proposed 150 x 305mm half battered kerb (Type HB1) laid as dropper at bus boarder KCC/1100/006.
  - T Proposed 125 x 150mm tapered kerb units (Type DL / DR or CKL / CKR\*) to KCC/1100/001/D.
  - Q3 PCC quadrant kerb (Type QHB305).
  - Buff PCC tactile paving 400 x 400mm. 50mm thick slabs, to KCC/1100/015. Blisters to align with tactile on opposite side of road.
  - Buff PCC tactile paving 400 x 400mm. 50mm thick slabs, to KCC/1100/015. Blisters to align with tactile on opposite side of road.
  - 50mm SMA 10 55 surface course 40/60 WTR2, 60mm SMA 14 60/20 WTR2, 185mm AC32 HDM Base 40/60, 165mm Type 1 Subbase 888AR
  - 50mm SMA10 surface course 40/60 WTR2 laid on, 60mm SMA 14 60/20 WTR2.
  - Reinstatement for carriageway: 50mm SMA10 surface course 40/60 WTR2
  - MMA "black colour" anti-skid material laid above existing surface.
  - New courtesy crossing feature using red, grey or buff surfacing (to be agreed on site with engineer). See details from KCC-HTW-1100-AT-1B
- 2 No. new Marshalls Reinforced Concrete speed cushions as per Technical Datasheet. Construction: AC32 subbase, Fast setting M80 based screed (with 1 day cure time before the surface course around the cushion is laid) and a AC10 surface course Approx. 135mm depth.
- Non-illuminated traffic sign (refer to Sign Schedule for details).
  - Sign position and orientation (refer to Sign Schedule for details)
  - New / Refreshed Road marking to TSRGD 2016 Diagram number.
  - White Road marking.
  - Yellow Road marking.
  - Timber bollard with red / white bands (see Sign Schedule).
- Site Clearance Key**
- Remove and dispose of existing kerb including bedding and backing. \* Disposed of at Contractor's licensed tip.
  - Remove road marking by hydroblasting
  - Take up existing blocks / pavers including sand/cement layer to store for reuse
  - Mill bituminous carriageway depth 100mm but not exceeding 125mm coal tar contaminated
  - Mill bituminous carriageway depth not exceeding 50mm
  - Break-out and dispose of existing concrete material
  - Excavate soft material to a depth of 100mm and tip
  - Backfilling disused gully internal diameter 400mm with in situ concrete ST2.
  - Bollard to be taken up and set aside for reuse
  - Tangent Point
  - Sign (and post) to be removed (refer to Sign Schedule).
- Drainage Key**
- MH Take up and adjust manhole cover to new level.
  - AM Take up and adjust medium service cover to new level.
  - AS Take up and adjust small service cover to new level.
  - AG Adjust existing gully grating and frame.
  - NG PCC trapped gully with class D400 grate as KCC/SD/500/009.
  - Connection of 1500 pipe to new PCC chamber.
  - 1500 Twin wall pipe in Type S bed and surround.
  - MH New manhole chamber design group 1a (refer to KCC/SD/500/001 for details).
  - Existing road gully
- Street Lighting**
- New lamp column (see illuminated Sign Schedule).
  - New belisha beacon (see illuminated Sign Schedule).
- Soft Landscaping**
- 12-14cm girth Field Maple Tree "Acer Campestris" and pit (see drawing details KCC-HTW-300-11). Pit volume 0.75 x 0.75 x 0.5m

		<b>Kent County Council</b> Ashford Highway Depot Henwood Industrial Estate Ashford TN24 8AD Tel: 03000 418181
---	--	--

Project		Active Travel	
Faversham Cross Town Improvements		Design Drawing	
Sheet 6		Detailed Design	
Scale	1:200 at A1	Do not scale	
Drawing number	23-SW-AC-873-02	Rev	A