

Notes  
1. Road markings and traffic signal head positions are indicative only.

**KEY**

- Carriageway Improvement
- Verge / Earthworks / Landscaping
- Footway with Enhanced Materials
- Footway with Standard Materials
- Non Pedestrian Hardstanding
- Existing Area of Vegetation / Soft Landscaping to remain

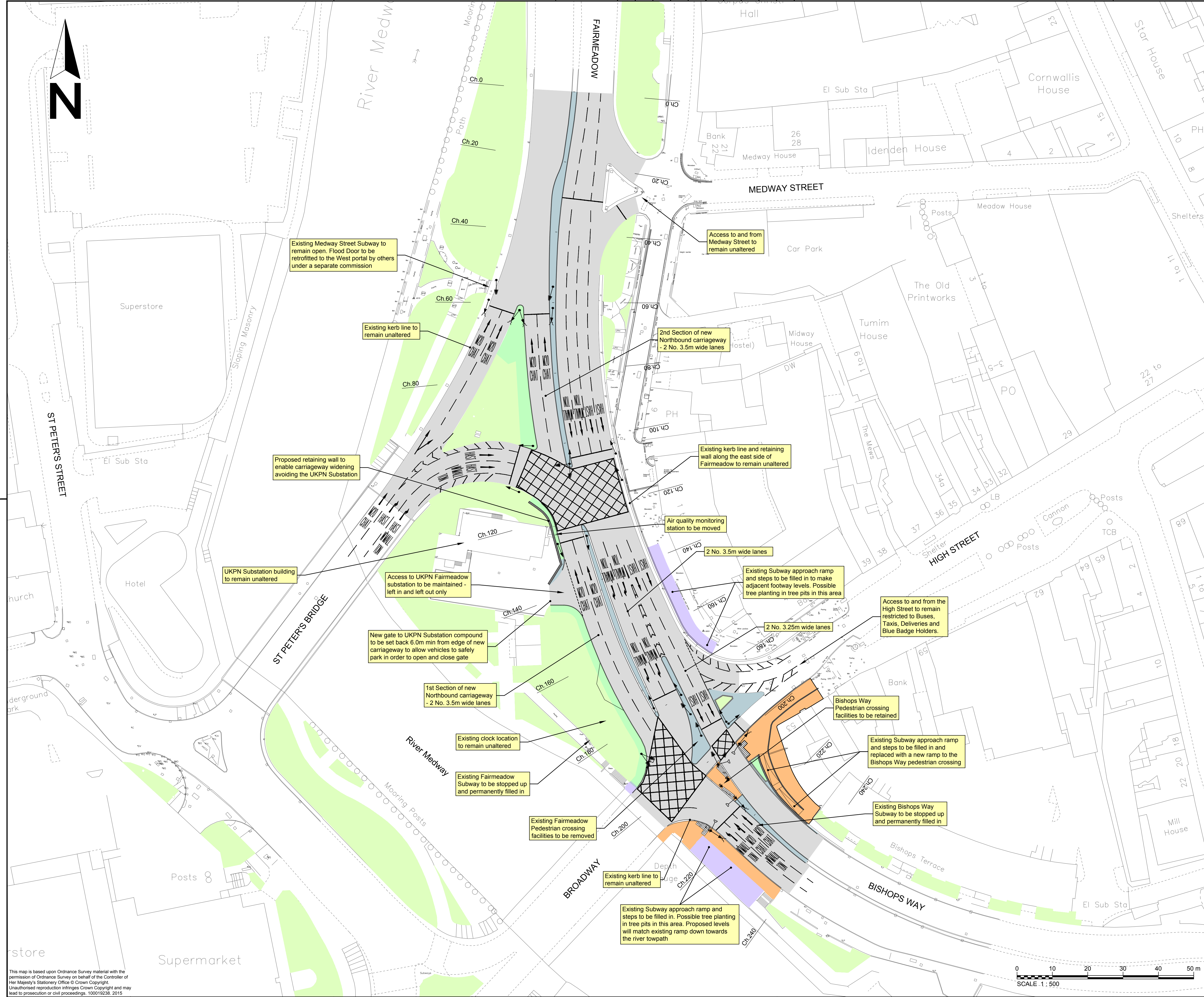

|     |  |      |      |          |
|-----|--|------|------|----------|
| 6   | Highway alignment amendments   | JAP  | JAP  | 15-01-15 |
| 5   | Fairmeadow Subway ramp and steps infill and possible tree planting locations added         | JAP  | JAP  | 20-11-15 |
| 4   | Existing Vegetation added for clarity. Subway annotations & Additional Footway areas added | JAP  | JAP  | 13-11-15 |
| 3   | High St access amended and footway material classification added                           | JAP  | JAP  | 27-10-15 |
| 2   | Central Splitter Islands Amended   | JAP  | JAP  | 20-08-15 |
| 1   | Extents of Carriageway Improvement Amended   | JAP  | JAP  | 26-05-15 |
| Rev | Revision details   | Chkd | Appd | Date     |

|         |                  |                  |   |
|---------|------------------|------------------|---|
| Drawn:  | TMW              | Preliminary      | ✓ |
| Design: |                  | For comment      |   |
| Chkd:   | JAP              | For tender       |   |
| Appd:   | API              | For construction |   |
| Date:   | 19 February 2015 | As constructed   |   |
|         |                  | Other            |   |



Client  
**MAIDSTONE GYRATORY**

Project Name  
**MAIDSTONE GYRATORY**

Drawing Title  
**Scheme Plan**

Original Drawing Size : A1      Dimensions : -  
Scale : 1:500      Copyright © Amey

Drawing No  
**4300273/000/02**

Rev  
**6**

This map is based upon Ordnance Survey material with the permission of Ordnance Survey on behalf of the Controller of Her Majesty's Stationery Office © Crown Copyright. Unauthorised reproduction infringes Crown Copyright and may lead to prosecution or civil proceedings. 100019238, 2015

