

**Form CA17**

**Notice of landowner deposits under section 31(6) of the Highways Act 1980  
and section 15A(1) of the Commons Act 2006**

**The Kent County Council**

An application to deposit a map and statement and subsequently lodge a declaration under section 31(6) of the Highways Act 1980 and deposit a statement under section 15A(1) of the Commons Act 2006 has been made in relation to the land (or lands) described below and shown edged red on the accompanying map.

**PLEASE NOTE:**

**This deposit may affect rights over the land described below. Deposits made under section 31(6) of the Highways Act 1980 may prevent deemed dedication of public rights of way over such land under section 31(1) of that Act. Deposits made under section 15A(1) of the Commons Act 2006 may affect the ability to register such land as a town or village green under section 15 of that Act.**

**Please see guidance at:**

**<http://www.defra.gov.uk/rural/protected/greens/> for further information.**

*Description of the lands:*

Stoneheap, Little Mongham, Deal, Kent, CT14 0HS (Map A); New Downs Farm, New Downs, Sandwich, Kent, CT13 9PE (Map B)

*Name of the Parish, Ward or District in which the lands are situated:*

Northbourne, Sutton - Dover; Worth - Dover

The deposit was submitted by James Hole of Strutt & Parker on behalf of Betteshanger Investments Limited and was received by this authority on 30/09/2014. The authority maintains a register of maps, statements and declarations deposited under section 31(6) of the Highways Act 1980 and section 15B of the Commons Act 2006.

This register can be accessed online at: <http://www.kent.gov.uk/waste-planning-and-land/public-rights-of-way/landowner-protection> or can be inspected free of charge at the address below at the times indicated below:

PROW & Access Service, Invicta House – 2<sup>nd</sup> Floor, County Hall, Maidstone, Kent, ME14 1XX Monday-Friday between the hours of 10.00am-4.00pm. It is advised that appointment is made beforehand by telephoning 03000 41 71 71.

Signed on behalf of **The Kent County Council:**



*Name and Position of Signatory:* Mike Overbeke,  
Head of Public Protection

Date: 20<sup>th</sup> October 2014





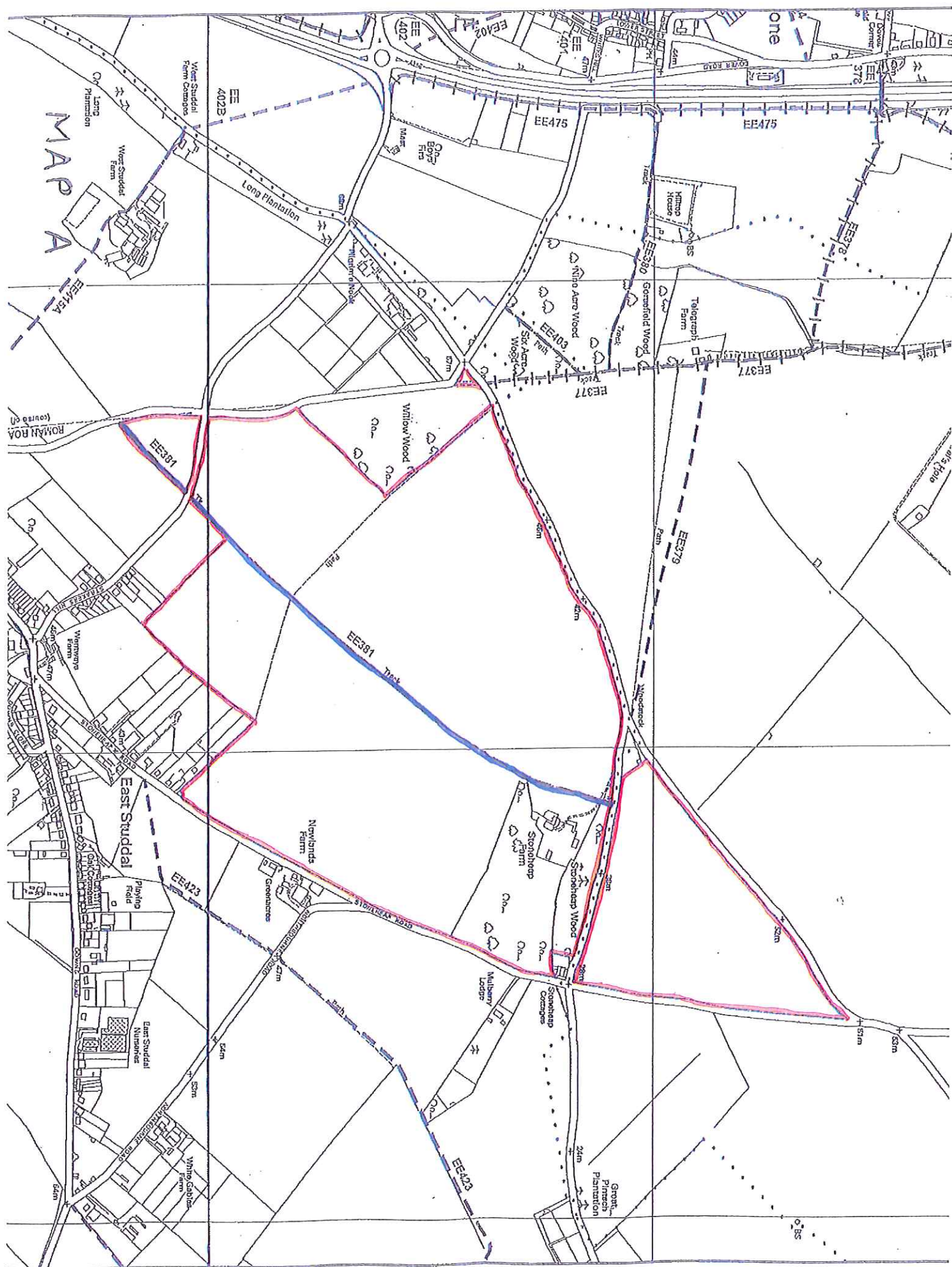



MAP  
B

MAP NOT TO  
ORIGINAL SCALE

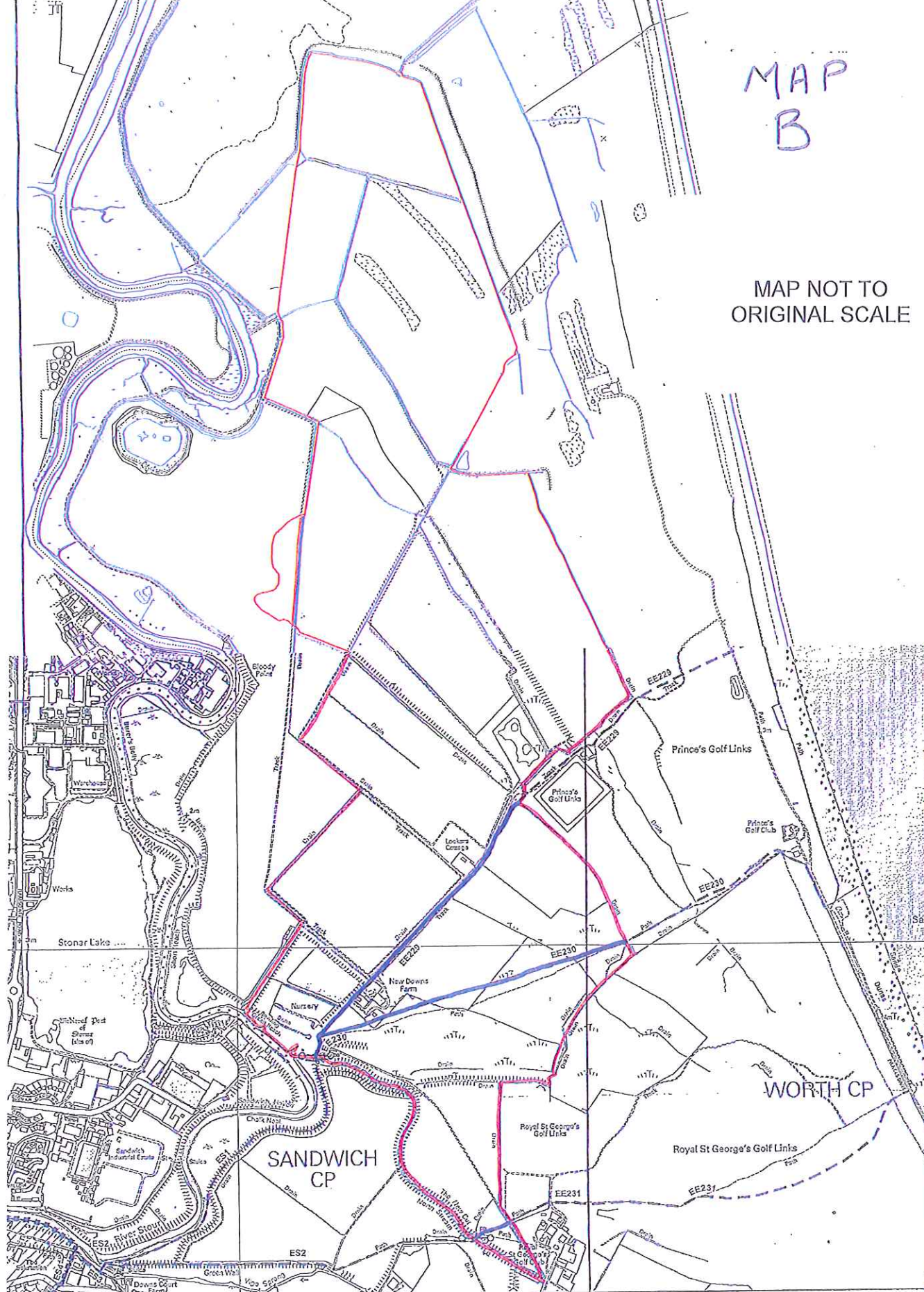

KEY

- Footpath
- |—| Bridleway
- ~—~ Restricted Byway
- ~~~ Bwway Open to All Traffic

EXTRACT OF THE WORKING COPY OF THE  
DEFINITIVE MAP OF PUBLIC RIGHTS OF WAY  
FOR THE COUNTY OF KENT

© Crown Copyright and database right 2013. Ordnance Survey 100019238

**FOR REFERENCE ONLY – NO FURTHER COPIES  
MAY BE MADE**

Unauthorised reproduction infringes Crown Copyright  
and may lead to prosecution or civil proceedings.

Created by:  
MMcL

Issue date:  
26/09/2014

Reference:  
Northbourne Estate

Map sheets  
181 (TR36SW)  
178 (TR35NW)  
490 (TR25NE)

N



1:10,000