

## Station Road, Westgate On Sea

### Trial scheme to reallocate road space and introduce a one-way system

---

#### What are we planning to do?

- Introduce a one-way system in a westbound direction along Station Road between Roxborough Road and St Mildred's Road.
- Removal of 5 parking bays on St Mildred's Road allowing for new amenity space and extra room for pedestrians in line with social distancing guidelines, 2 additional parking bays will be provided on Station Road at its junction with Roxburgh Road.

The scheme will be implemented using temporary measures, such as planters and bolt down bollards, so that changes can quickly be made if required. The above measures will also help enhance the streetscape through the use of outdoor seating areas and planters. Please see reverse for a plan of the scheme design. The trial can last for a maximum of 18 months, but the trial can be ended sooner or made permanent depending on how well received the scheme is.

#### When will the work start?

Installation started on 07/09/2020 and will take up to 2 weeks to complete. The one way system will become active once it has been advertised in the Thanet Gazette.

#### How will we carry out the works and how will it affect you?

The scheme will be carried out using local traffic management through a combination of temporary traffic signals, signing and guarding. Access will be maintained wherever safe to do so.

Following concerns raised by residents regarding the scheme at Station Road, Westgate the local County Council Members, Emma Dawson and Liz Hurst, instigated a meeting with the Leader of KCC, KCC Highways Cabinet Member, KCC Officers and the local MP Sir Roger Gale. To make sure that the opportunity for highway improvements in Westgate is not lost KCC is going to proceed with the trial one way system. Following initial feedback from residents and businesses notable changes have been made to address many of the concerns raised. To ensure that no more than 5 on street parking spaces will be removed in Station Road the scheme has been redesigned. The parking spaces to be removed will be located at the junction of Station Road and St Mildred's Road. Additional parking is to be provided on Station Road near the junction with Roxburgh Road by removing some of the existing double yellow lines which are not needed whilst the one way system is in place. 3 parking spaces will be removed in total, this is required for the trial to be safely implemented, and ensure drivers do not travel the wrong way on Station Road

#### Why do we want to do this work?

The UK Government has made £1.6m of funding available to Kent County Council to provide new or improve existing walking and cycling facilities in order to promote active travel as a result of the COVID-19 pandemic. This money needs to be spent by mid-September (within 8 weeks of being awarded), which means we have not been able to carry out the levels of engagement and consultation that we normally would.

Please be assured that these measures are initially planned to be temporary (for up to 18 months) and will continue to be monitored throughout the trial period before any final decisions as to their long-term implementation are made. There is flexibility in the design to allow for further alterations to improve the effectiveness of the scheme if

# COVID-19 Emergency Active Travel Fund Promoting walking and cycling facilities



## Revised scheme

these are considered necessary. KCC officers will be reviewing the site regularity and shall be commissioning survey equipment later this month to review how the one way system is working.

### How to get in touch

KCC will be recording all responses during the trial and these will be reported back to elected officials before any further amendments are proposed. For further information or to find out more please call us on 03000 41 81 81 and ask to speak to a member of the Schemes Planning & Delivery team. Alternatively you can email the team directly on [activetravelfund@kent.gov.uk](mailto:activetravelfund@kent.gov.uk)

Details and updates regarding Station Road and all of the Emergency Active Travel Fund Schemes will be available on the KCC Website [www.kent.gov.uk](http://www.kent.gov.uk) and search for active travel fund.

**WARNING – Beware Bogus Callers** Kent County Council Highways & Transportation do not allow works to be carried out on private properties. If anyone says they are working for us or our specialist contractors and offer to carry out any work for cash they should be treated with caution and you are advised to **contact** Citizens Advice Consumer Service Helpline on 03454 04 05 0

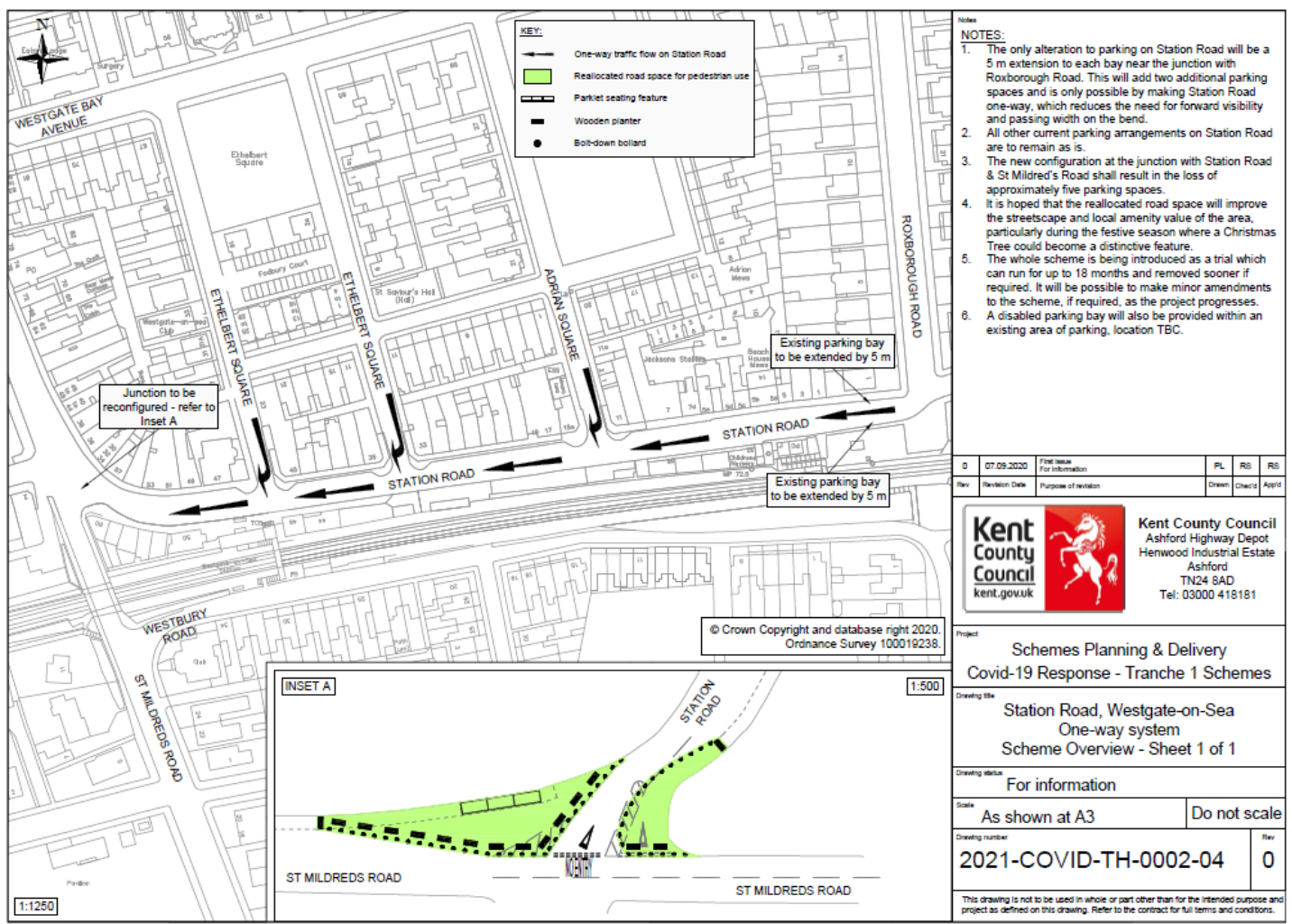

Rev	Revision Date	Purpose of revision	Drawn	Checked	App'd
0	07.09.2020	Final issue For information	PL	RS	RS

**Kent County Council**  
  
 Kent County Council  
 Ashford Highway Depot  
 Henwood Industrial Estate  
 Ashford  
 TN24 8AD  
 Tel: 03000 418181

Project	
Schemes Planning & Delivery Covid-19 Response - Tranche 1 Schemes	
Drawing title	
Station Road, Westgate-on-Sea One-way system Scheme Overview - Sheet 1 of 1	
Drawing status	
For information	
Scale	Do not scale
As shown at A3	
Drawing number	Rev
2021-COVID-TH-0002-04	0
This drawing is not to be used in whole or part other than for the intended purpose and project as defined on this drawing. Refer to the contract for full terms and conditions.	

**Page intentionally left blank**