

A299 Thanet Way roadworks – Contraflow Plan

Traffic management arrangements whilst the contraflow system is active.

Map of contraflow arrangements (page 1 of 2)



A299 Thanet Way roadworks – Contraflow Plan

Traffic management arrangements whilst the contraflow system is active.

Map of contraflow arrangements (page 2 of 2)



A299 Thanet Way roadworks – Contraflow Plan

Traffic management arrangements whilst the contraflow system is active.

Map of enlarged detail for contraflow entry and offslip to Whitstable

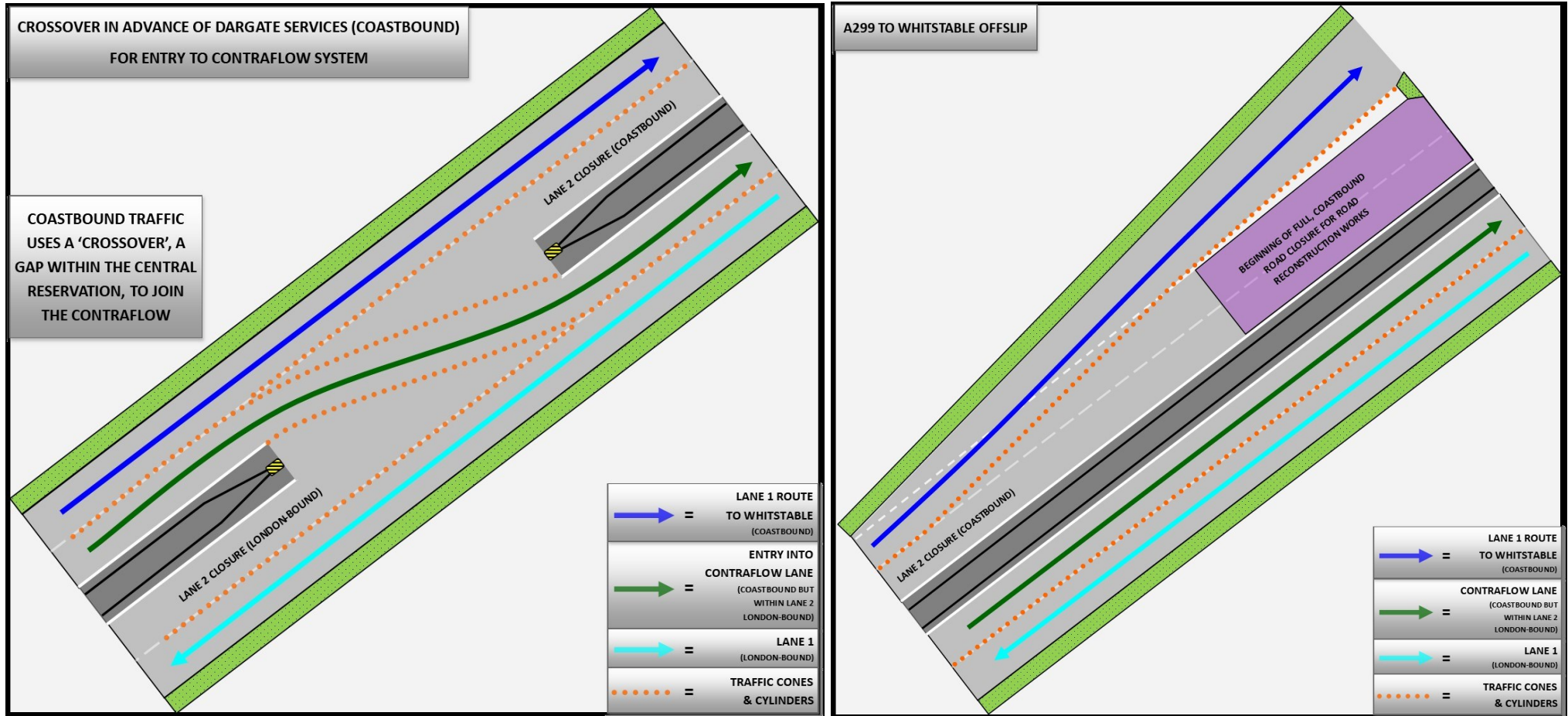

A299 Thanet Way roadworks – Contraflow Plan

Traffic management arrangements whilst the contraflow system is active.

Map of enlarged detail for onslip from Whitstable and contraflow exit

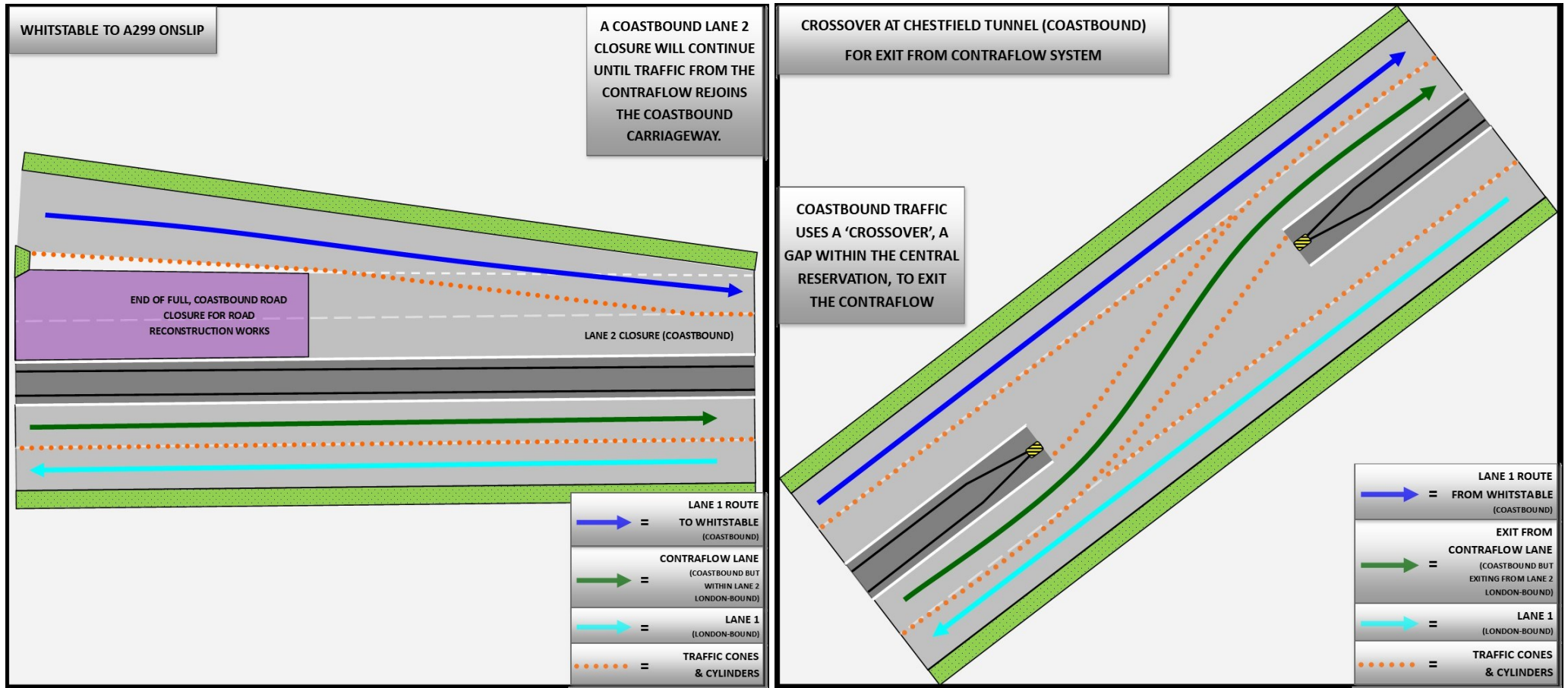

Plan details

Contraflow Arrangements

A contraflow is a temporary arrangement where traffic on a road is transferred from its usual side to share the other half of the carriageway with traffic moving in the opposite direction.

When heading in an eastbound (coastbound) direction, on the approach to the contraflow there will be two options. Traffic wanting to exit at Whitstable will be able to continue in lane 1 on the eastbound carriageway where they will exit the Thanet Way as normal.

For traffic wishing to continue eastbound (coastbound) past Whitstable, you will be guided into lane 2, where road users will utilise the contraflow system to continue your journey east but on the westbound (London-bound) carriageway. You will return to the eastbound carriageway side of the road shortly before the Chestfield Tunnel.

Throughout the contraflow system, traffic on the London bound carriageway will be divided by traffic cylinders, which are like traffic cones but of a semi-permanent nature.

As this reconstruction work takes place between the eastbound (coastbound) Whitstable off and on slips, when exiting the town, you will still be able to rejoin the A299 in an eastbound (coastbound) direction in lane 1 and shortly before the Chestfield Tunnel, lane 1 traffic will merge with lane 2 traffic which has returned from the contraflow system, onto the eastbound (coastbound) carriageway.