

**KENT COUNTY COUNCIL**  
**REGISTER OF DEPOSITS**



KCC Reference number: **TH/ROW4/HQ/450**

- ✓ Highways Statement
- ✓ Landowner Statement
- ✓ Highways Declaration

Date Deposit application received: **10/11/2017**

Date on which any Highways Declaration expires: **28/11/2037**

.....

Details of the land:

Districts	<b>Ashford; Canterbury; Dover</b>
Parishes	<b>Ash, Preston, Staple, Wingham, Woodnesborough, Worth (Dover); Chartham, Wickhambreaux (Canterbury); Chilham (Ashford)</b>
Address & postcode of buildings on land parcels	<b>Map 1 - Pedding &amp; Brook Field Farm, Brook Farm, Staple Road, Wingham, Kent, CT3 1PL; Map 2 - Land at Hoaden, Walmstone Road, Nash, Ash, Kent, CT3 2JX; Land at Hoaden, Sheerwater Road, Hoaden, Ash, Kent, CT3 2LJ; Map 3 - Land at Westmarsh, Wass Drove, Westmarsh, Kent, CT3 2LW; Map 4 - Land at Preston, Grove Road, Grove, Kent, CT3 4BL; Land at Preston, The Street, Preston, Canterbury, Kent, CT3 1DZ;</b>

	<p><b>Map 5 - Land at Sand Pitts, Preston Hill, Wingham, Kent, CT3 1DA;</b>  <b>Map 6 - Land at Chartham, Ashford Road, Chartham, Kent, CT4 7SE;</b>  <b>Land at Chartham, Shalmsford Street, Chartham, Kent, CT47DJ;</b>  <b>Land at Chartham, Thruxted Lane, Chartham, Kent, CT4 7RT;</b> <b>Land at Chartham, Mysole Lane, Chartham, Kent, CT4 7QN;</b>  <b>Map 7 - Land at Sandwich Flats, Ash Road, Sandwich, CT13 9JB;</b>  <b>Map 8 - Land at Sandwich Bay, Ramsgate Road, Sandwich, Kent, CT13 9NW.</b></p>
Nearest town/city	<b>See box below</b>
OS 6-figure grid reference	<p><b>TR 093 549 - Chartham;</b>  <b>TR 261 573 - Wingham;</b>  <b>TR 248 584 - Wingham;</b>  <b>TR 244 620 - Preston;</b>  <b>TR 270 615 - Westmarsh;</b>  <b>TR 269 602 - Preston;</b>  <b>TR 315 587 - Sandwich;</b>  <b>TR 341 605 - Sandwich</b></p>

KCC Contact: Definitive Map Officer

Tel: 03000 41 71 71

Email: [prow@kent.gov.uk](mailto:prow@kent.gov.uk)

## Form CA17

### Notice of landowner deposit statement under section 31(6) of the Highways Act 1980 and/or section 15A(1) of the Commons Act 2006

#### The Kent County Council

An application to deposit a map and statement and subsequently lodge a declaration under section 31(6) of the Highways Act 1980 and deposit a statement under section 15A(1) of the Commons Act 2006 has been made in relation to the land described below and shown edged red on the accompanying map, reference **32/17**. Deposit applications enable a landowner to protect their land against the establishment of any/further public rights of way and/or registration of the land as a village green.

#### PLEASE NOTE:

This deposit does not affect existing recorded public rights of way but may affect any unrecorded rights over the land described below. Deposits made under section 31(6) of the Highways Act 1980 may prevent deemed dedication of public rights of way over such land under section 31(1) of that Act. Deposits made under section 15A(1) of the Commons Act 2006 may affect the ability to register such land as a town or village green under section 15 of that Act. Please see guidance at:

<http://www.defra.gov.uk/rural/protected/greens/> for further information.

There is no means of objection to this statement.

#### *Description of the land:*

Map 1 - Pedding & Brook Field Farm, Wingham; Map 2 - Land at Hoaden; Map 3 - Land at Westmarsh, Wass Drove; Map 4 - Land at Preston; Map 5 - Land at Sand Pitts, Wingham; Map 6 - Land at Chartham; Map 7 - Land at Sandwich Flats; Map 8 - Land at Sandwich Bay.

#### *Name of the Parish, Ward or District in which the land is situated:*

Ash, Preston, Staple, Wingham, Woodnesborough, Worth - Dover;  
Chartham, Wickhambreaux - Canterbury; Chilham - Ashford

The deposit was submitted by Edward Plumptre (BTF) for A.C.Hulme & Sons and was received by this authority on 10/11/2017.

The authority maintains a register of maps, statements and declarations deposited under section 31(6) of the Highways Act 1980 and section 15B of the Commons Act 2006.

This register can be accessed online at: <http://www.kent.gov.uk/waste-planning-and-land/public-rights-of-way/landowner-protection> or can be inspected free of charge at the address below at the times indicated below:

PROW & Access Service, Invicta House – County Hall, Maidstone, Kent, ME14 1XX  
Monday-Friday between the hours of 10.00am-4.00pm. For further information on this subject or to make an appointment to view the register in the office, please contact **Mrs Maria McLauchlan on 03000 413420**.

Signed on behalf of **The Kent County Council:**



*Name and Position of Signatory:* Mike Overbeke,  
Head of Public Protection

Date: 14<sup>th</sup> December 2017



**This notice may be removed after 14<sup>th</sup> February 2018**

## Application Form

## Form CA16

**Application Form for deposits under section 31(6) of the Highways Act 1980 and section 15A(1) of the Commons Act 2006****Please read the following guidance carefully before completing this form**

1. *Guidance relating to completion of this form is available from <https://www.gov.uk/town-and-village-greens-how-to-register>. Please refer to these separate notes when completing this form.*
2. *Parts A and F must be completed in all cases.*
3. *The form must be signed and dated by, or by a duly authorised representative of, every owner of land to which the application relates who is an individual, and by the secretary or some other duly authorised officer of every owner of land to which the application relates which is a body corporate or an unincorporated association.*
4. *In the case of land in joint ownership all the joint owners must complete paragraphs 2 and 3 of Part A and complete and sign the application in Part F, unless a duly authorised representative completes and signs the form on behalf of all of the owners of the land. Paragraph 3 should be completed in full to clearly explain the capacity of each applicant e.g. trustee, landowner's managing agent, executor.*
5. *'Owner' is defined in section 61(3) of the Commons Act 2006 and section 31(7) of the Highways Act 1980 and means, broadly, a legal owner of the freehold interest in the land.*
6. *Where the application relates to more than one parcel of land, a description of each parcel should be included in Paragraph 4 of Part A and the remainder of the form should be completed to clearly identify which statement and/or declaration relates to which parcel of land. This may require the insertion of additional wording. See separate notes for further guidance. Multiple parcels of land should be clearly identified by coloured edging on any accompanying map.*
7. *Where a statement or declaration requires reference to colouring shown on an accompanying map or previously lodged map, the colouring must be clearly specified and must match that shown on the relevant map. For example, if a footpath is specified in a Part C declaration as shown coloured brown, the accompanying map or previously deposited map referred to must reflect that colouring.*
8. *An application must be accompanied by an ordnance map, or (in respect of declarations under Part C or statements under Part D of this form) refer to a map previously deposited in accordance with the Commons (Registration of Town or Village Greens) and Dedicated Highways (Landowner Statements and Declaration) (England) Regulations 2013 or (if deposited before 1st October 2013) in accordance with section 31(6) of the Highways Act 1980. Any accompanying map must be an ordnance map at a scale of not less than 1:10,560 showing the boundary of the land to which the application relates in coloured edging.*
9. *An application must be accompanied by the requisite fee – please ask the appropriate authority for details.*

10. 'Appropriate authority' means (a) in relation to a map or statement deposited or declaration lodged under section 31(6) of that Act, an appropriate council (as defined in section 31(7) of the Highways Act 1980); and (b) in relation to a statement and map deposited under section 15A(1) of the 2006 Act, a commons registration authority (defined in section 4 of the Commons Act 2006 and section 2 of the Commons Registration Act 1965). In practice, the appropriate council and commons registration authority will usually be the same body.

**PART A: Information relating to the applicant and land to which the application relates  
(all applicants must complete this Part)**

1. Name of appropriate authority to which the application is addressed: Kent County Council

2. Name and full address (including postcode) of applicant: Edward Plumptre

BTF Partnership, Clockhouse Barn, Canterbury Road, Challock, Ashford, Kent, TN25 4BJ

3. Status of applicant (tick relevant box or boxes):

I am

(a)  the owner of the land(s) described in paragraph 4.

(b)  making this application and the statement it contains on behalf of **A.C. Hulme & Sons** who are the owner of the lands described in paragraph 4 and in my capacity as the landowners managing agent.

4. Insert description of the lands to which the application relates (including full address and postcode):  
The subject land is shown edged red on the plans accompanying this statement and they are described as follows.

Map 1: Pedding & Brook Field Farm (Parcel A), Brook Farm, Staple Road, Wingham, Canterbury, Kent CT3 1PL. The subject land is 237.21 Hectares (586.18 Acres) with road frontage to Staple Road, Durlock Road and A257.

Map 1: Pedding and Brook Field Farm (Parcel B), Brook Farm, Staple Road, Wingham, Canterbury, Kent CT3 1PL. The subject land is 9.00 Hectares (19.77 Acres) with road frontage St Mary's Road.

Map 2: Land at Hoaden (Parcel A), Walmestone Road, Nash, Ash, Canterbury, Kent CT3 2JX. The subject land is 5.77 Hectares (14.27 Acres) with road frontage to Walmestone Road.

Map 2: Land at Hoaden (Parcel B), Sheerwater Road, Hoaden, Ash, Canterbury, Kent CT3 1HJ. The subject land is 35.79 Hectares (88.43 Acres) with road frontage to Sheerwater Road, Church Hill and Hoaden Lane.

Map 2: Land at Hoaden (Parcel C), Sheerwater Road, Hoaden, Ash, Canterbury, Kent CT3 2LJ. The subject land is 5.65 Hectares (13.97 Acres) with road frontage to Sheerwater Road.

Map 2: Land at Hoaden (Parcel D), Sheerwater Road, Hoaden, Ash, Canterbury, Kent CT3 2LJ. The subject land is 4.85 Hectares (11.99 Acres) with road frontage to Sheerwater Road.

Map 2: Land at Hoaden (Parcel E), Hoaden Lane, Hoaden, Ash, Canterbury, Kent CT3 2LQ. The subject land is 61.48 Hectares (151.92 Acres) with road frontage to Hoaden Lane.

Map 3: Land at Westmarsh (Parcel A), Wass Drove, Westmarsh, Canterbury, Kent CT3 2LW. The subject land is 51.12 Hectares (126.34 Acres) with road frontage to Wass Drove.

Map 3: Land at Westmarsh (Parcel B), Wass Drove, Westmarsh, Canterbury, Kent CT3 2LW. The subject land is 6.36 Hectares (15.72 Acres) with road frontage to Wass Drove.

Map 4: Land at Preston (Parcel A), Grove Road, Grove, Canterbury, Kent CT3 4BL. The subject land is 32.63 Hectares (80.64 Acres) with road frontage to Grove Road.

Map 4: Land at Preston (Parcel B), The Street, Preston, Canterbury, Kent CT3 1DZ. The subject land is 8.05 Hectares (19.89 Acres).

Map 5: Land at Sand Pitts, Preston Hill, Wingham, Kent CT3 1DA. The subject land is 4.42 Hectares (10.94 Acres) with road frontage to Preston Hill.

Map 6: Land at Chartham (Parcel A), Ashford Road, Chartham, Canterbury, Kent CT4 7SE. The subject land is 48.05 Hectares (120.71 Acres) with road frontage to Ashford Road.

Map 6: Land at Chartham (Parcel B), Ashford Road, Chartham, Canterbury, Kent CT4 7NY. The subject land is 27.40 Hectares (67.71 Acres) with road frontage to Ashford Road.

Map 6: Land at Chartham (Parcel C), Shalmsford Street, Chartham, Canterbury, Kent CT4 7DJ. The subject land is 42.30 Hectares (104.52 Acres) with road frontage to Shalmsford Street.

Map 6: Land at Chartham (Parcel D), Shalmsford Street, Chartham, Kent CT4 8AG. The subject land is 13.01 Hectares (32.17 Acres) with road frontage to Shalmsford Street.

Map 6: Land at Chartham (Parcel E), Thruxted Lane, Chartham, Canterbury, Kent CT4 7RT. The subject land is 4.31 Hectares (10.66 Acres) with road frontage to Thruxted Lane and Bobbin Lodge Hill.

Map 6: Land at Chartham (Parcel F), Mysole Lane, Chartham, Canterbury, Kent CT4 7QN. The subject land is 41.49 Hectares (102.53 Acres) with road frontage to Shalmsford Street, Mystole Lane, Thruxted Lane and Bobbin Lodge Hill.

Map 7: Land at Sandwich Flats, Ash Road, Sandwich, Kent Ct13 9JB. The subject land is 5.98 Hectares (14.79 Acres).

Map 8: Land at Sandwich Bay, Ramsgate Road, Sandwich, Kent CT13 9NW. The subject land is 190.28 Hectares (470.21 Acres)

5. Ordnance Survey six-figure grid reference(s) of a point within the area of land(s) to which the application relates (if known):

Pedding and Brook Field Farm – TR259573

Land at Hoaden – TR268602

Land at Westmarsh – TR270615

Land at Preston – TR245621

Land at Sand Pitts – TR248584

Land at Chartham – TR094550

Land at Sandwich Flats – TR315587

Land at Sandwich Bay – TR338610

6. This deposit comprises the following statements:

**PART B: Statement under section 31(6) of the Highways Act 1980**

A.C. Hulme & Sons are the owner of the land described in paragraph 4 of Part A of this form and shown edged red on the maps accompanying this statement.

Ways shown in purple on the accompanying maps are public footpaths.

Ways shown in green on the accompanying maps are public bridleways

Ways shown in blue on the accompanying maps are restricted byways

No other ways over the land shown edged red on the accompanying maps have been dedicated as highways.

**PART D: Statement under section 15A(1) of the Commons Act 2006**

A.C. Hulme & Sons are the owner of the land described in paragraph 4 of Part A of this form and shown edged red on the map accompanying this statement.

A.C. Hulme & Sons wish to bring to an end any period during which persons may have indulged as of right in lawful sports and pastimes on the whole or any part of the land shown edged red on the accompanying maps referenced above.

**PART E: Additional information relevant to the application**  
*(insert any additional information relevant to the application)*

**PART F: Statement of Truth**  
*(all applicants must complete this Part)*

**WARNING:** If you dishonestly enter information or make a statement that you know is, or might be, untrue or misleading, and intend by doing so to make a gain for yourself or another person, or to cause loss or the risk of loss to another person, you may commit the offence of fraud under section 1 of the Fraud Act 2006, the maximum penalty for which is 10 years' imprisonment or an unlimited fine, or both.

**I BELIEVE THAT THE FACTS AND MATTERS CONTAINED IN THIS FORM ARE TRUE**

Signature (of the person making the statement of truth): 

Print full name: Edward Plumptre, BTF Partnership

Date: 09/11/2017

You should keep a copy of the completed form

**Data Protection Act 1998 - Fair Processing Notice**

The purpose of this Fair Processing Notice is to inform you of the use that will be made of your personal data, as required by the Data Protection Act 1998.

The appropriate authority (see explanation of definition in above guidance notes) in England is the data controller in respect of any personal data that you provide when you complete this form.

The information that you provide will be used by the appropriate authority in its duties to process applications to deposit statements, maps and declarations under section 31(6) the Highways Act 1980 and statements under section 15A(1) of the Commons Act 2006. The information you provide will also be used by the appropriate authority in its duty to update the registers in which details of such deposits are recorded under the Dedicated Highways (Registers under Section 31A of the Highways Act 1980) (England) Regulations 2007 and the Commons (Registration of Town or Village Greens) and Dedicated Highways (Landowner Statements and Declarations) (England) Regulations 2013.

The appropriate authority is required by the legislation above to maintain a register which holds information provided in this form, which can be inspected online or in person by members of the public on request. It may also be required to release information, including personal data and commercial information, on request under the Environmental Information Regulations 2004 or the Freedom of Information Act 2000. However, the appropriate authority will not permit any unwarranted breach of confidentiality nor will they act in contravention of their obligations under the Data Protection Act 1998.



# Pedding and Brook Field Farm

## Map 1 of 8

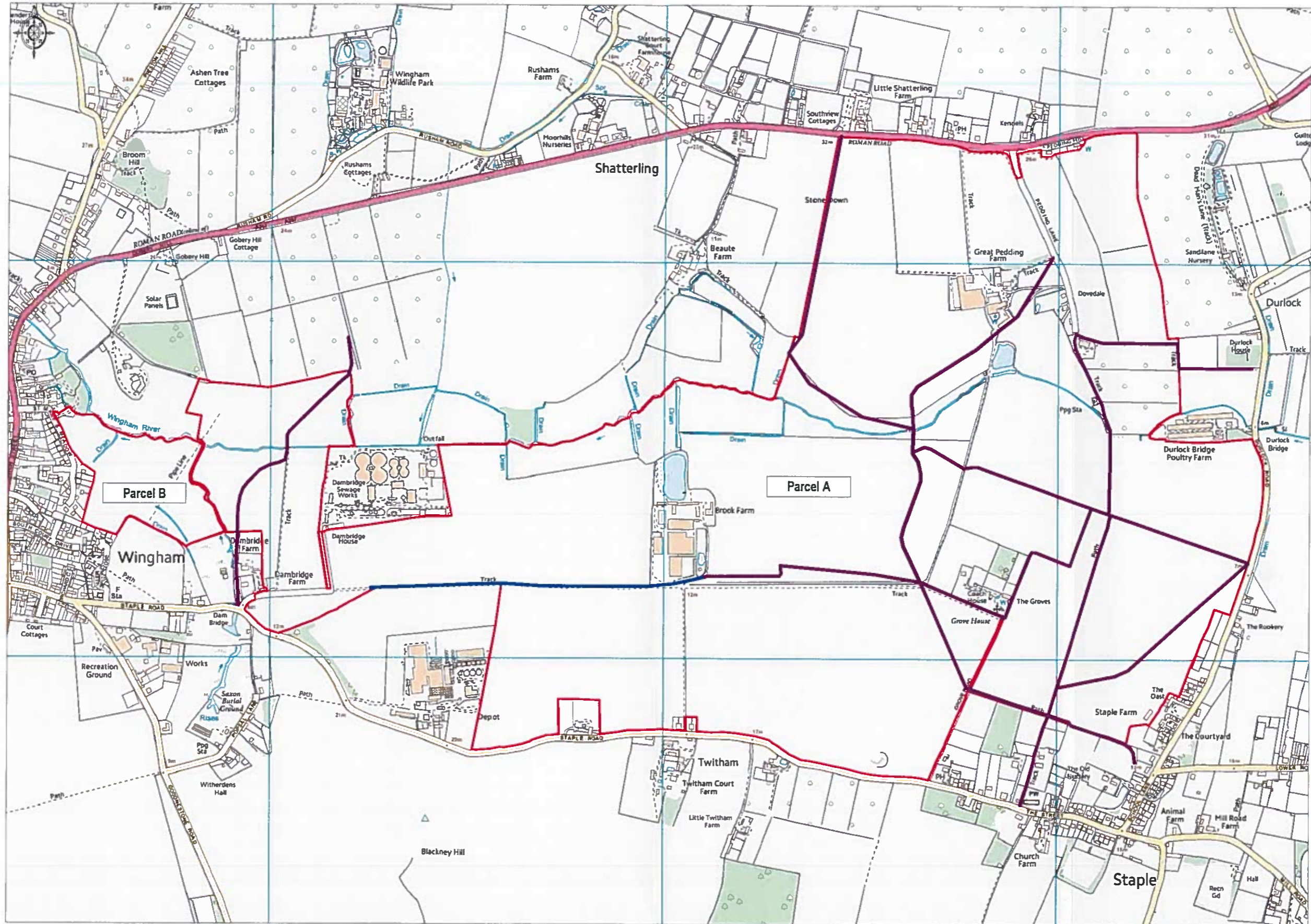

# Land at Hoaden Map 2 of 8

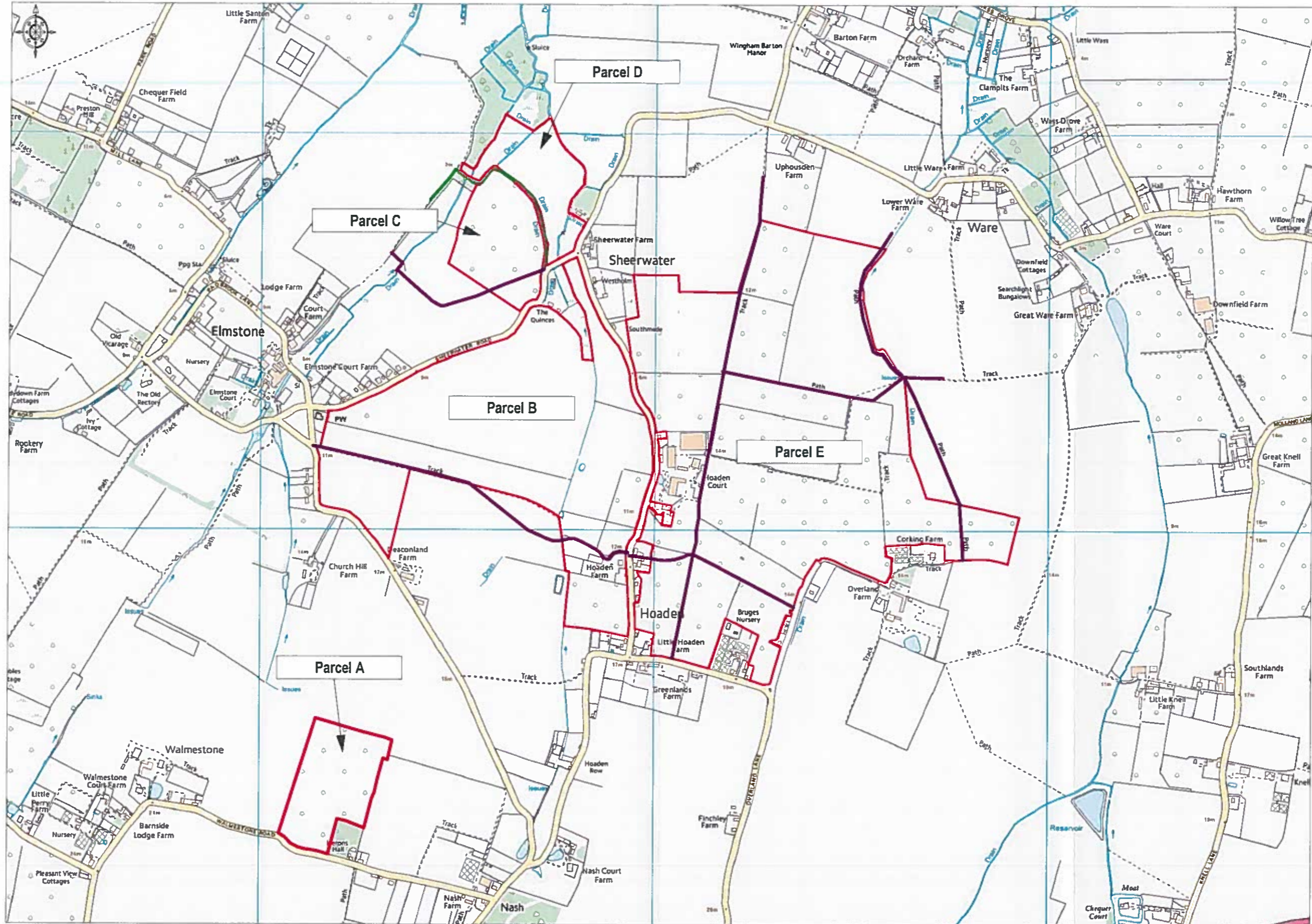

# Land at Westmarsh Map 3 of 8

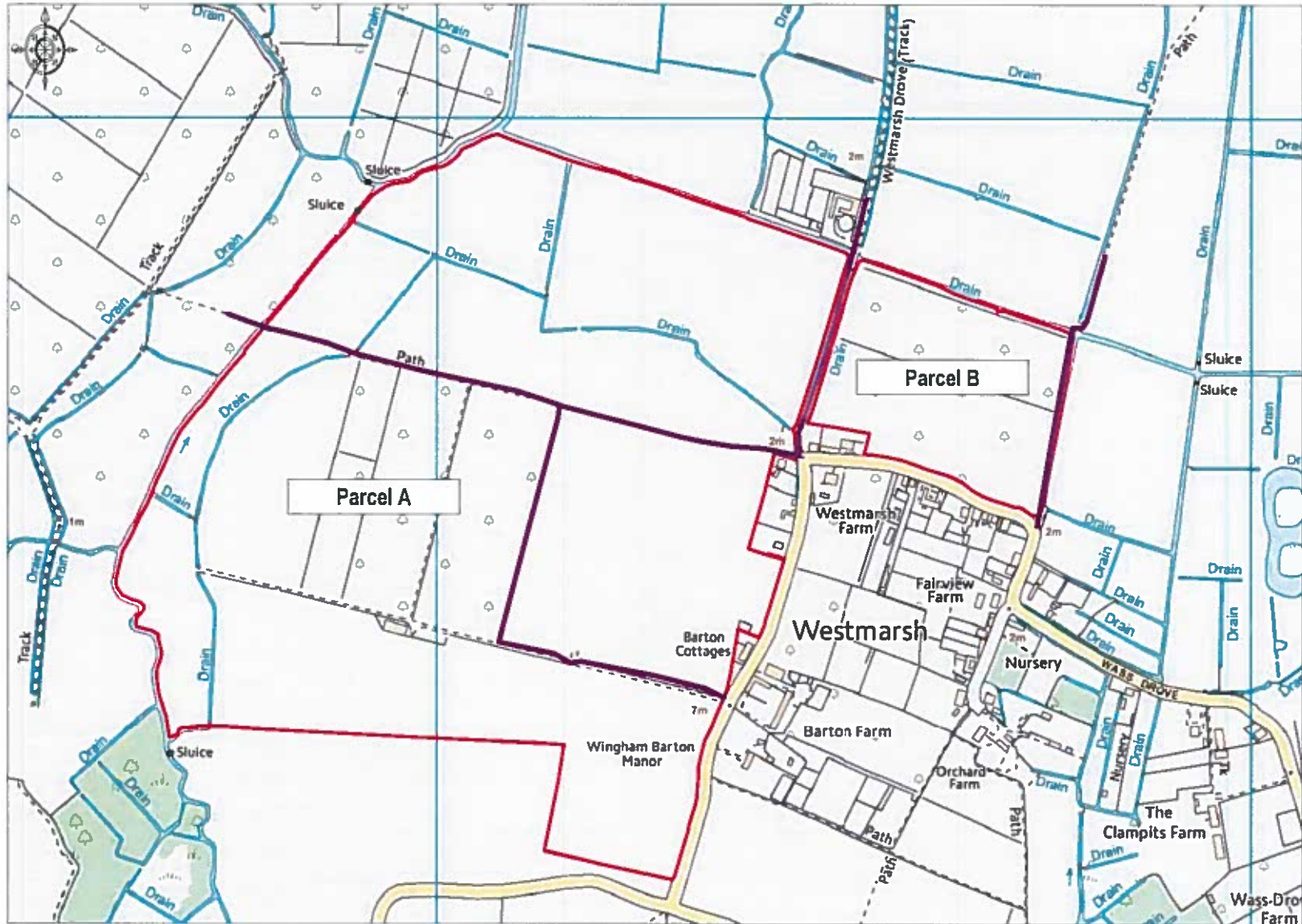

Ordnance Survey © Crown Copyright 2017 All rights reserved. Licence number 100021432. Plotted Scale - 1:7500

# Land at Preston

## Map 4 of 8

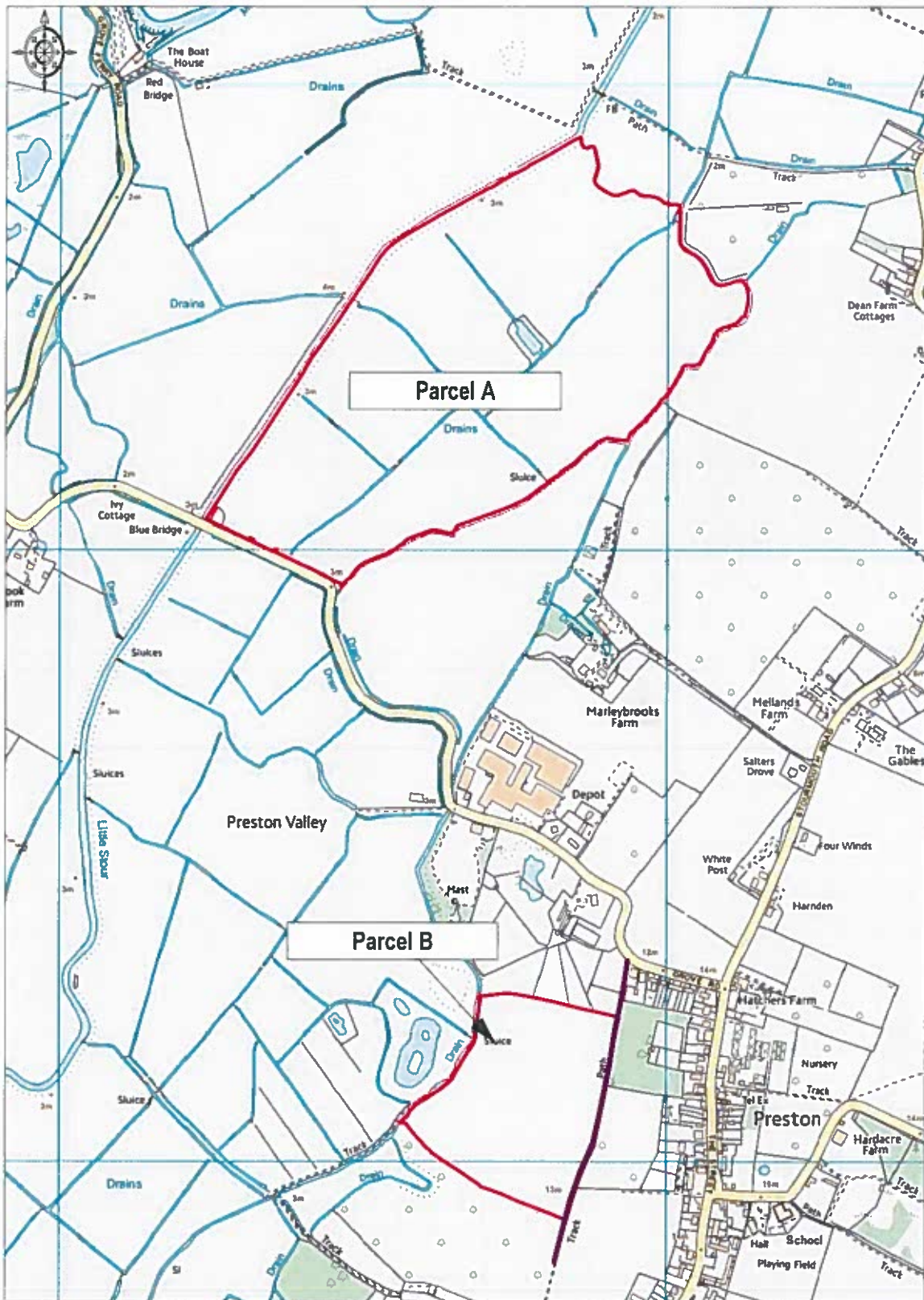

Ordnance Survey © Crown Copyright 2017. All rights reserved.  
Licence number 100022432. Plotted Scale - 1:10000

# Land at Sand Pitts

## Map 5 of 8

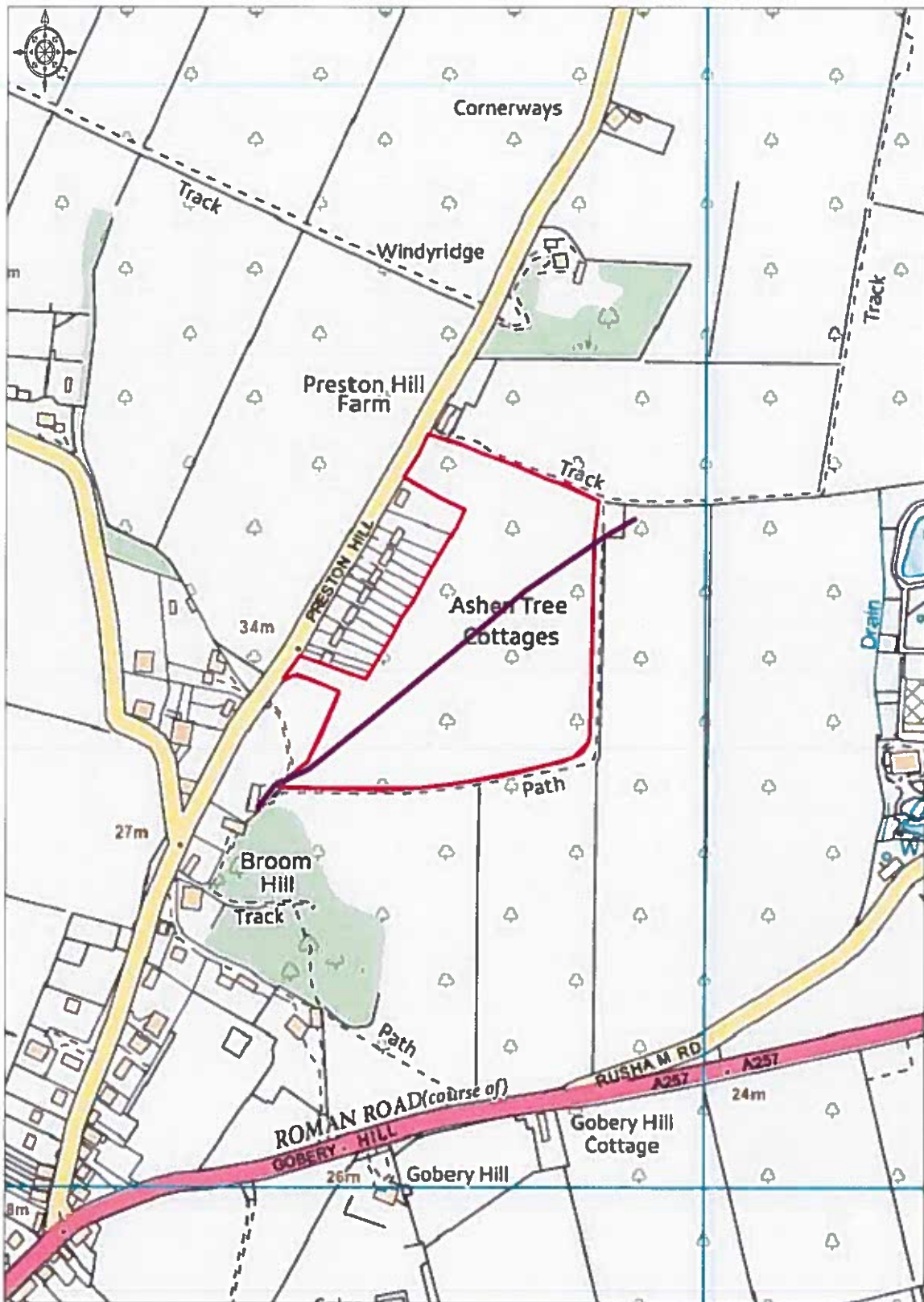

Ordnance Survey © Crown Copyright 2017 All rights reserved.  
Licence number 100022432. Plotted Scale - 1:5000

# Land at Chartham Map 6 of 8

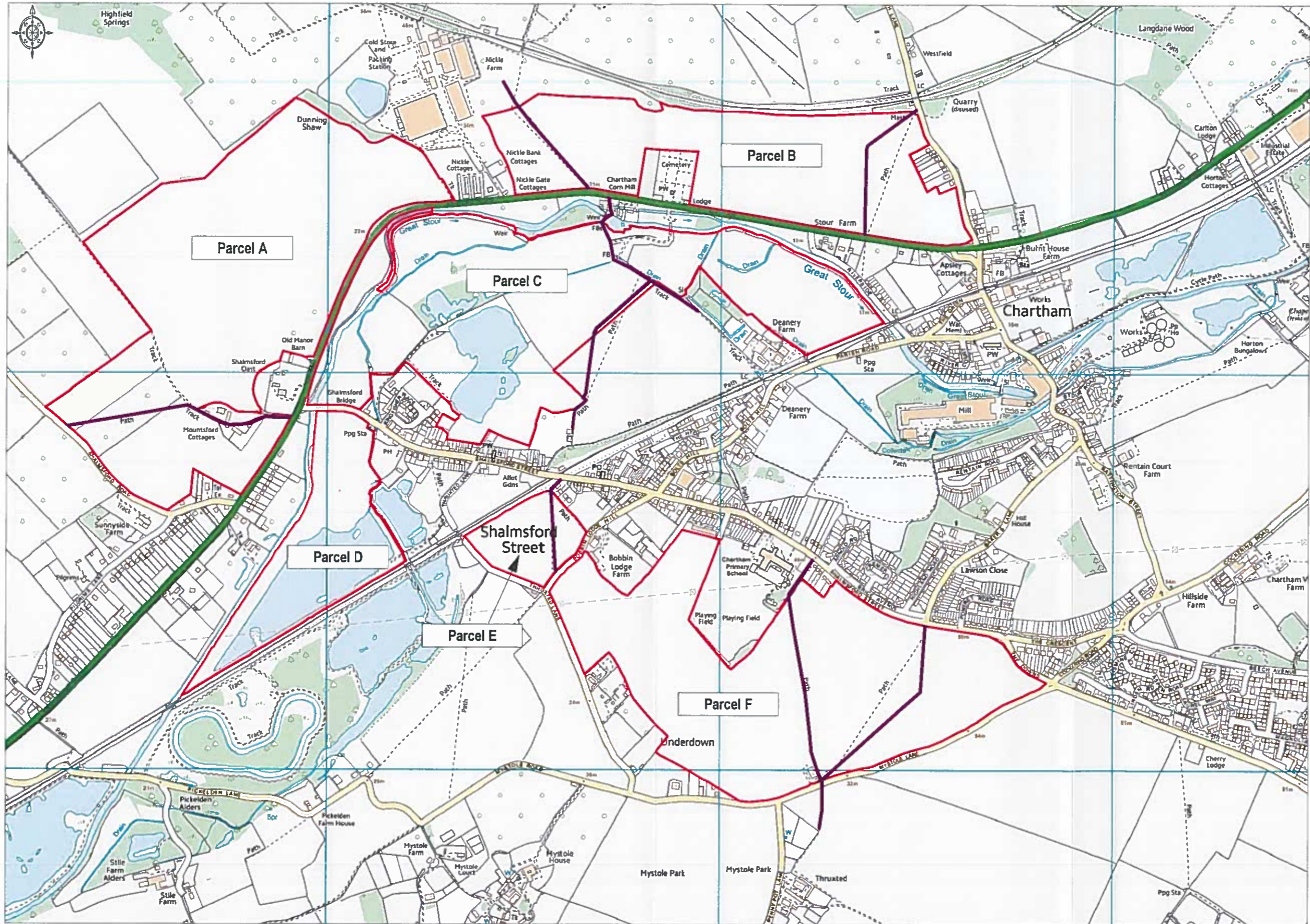

# Land at Sandwich Flats

## Map 7 of 8

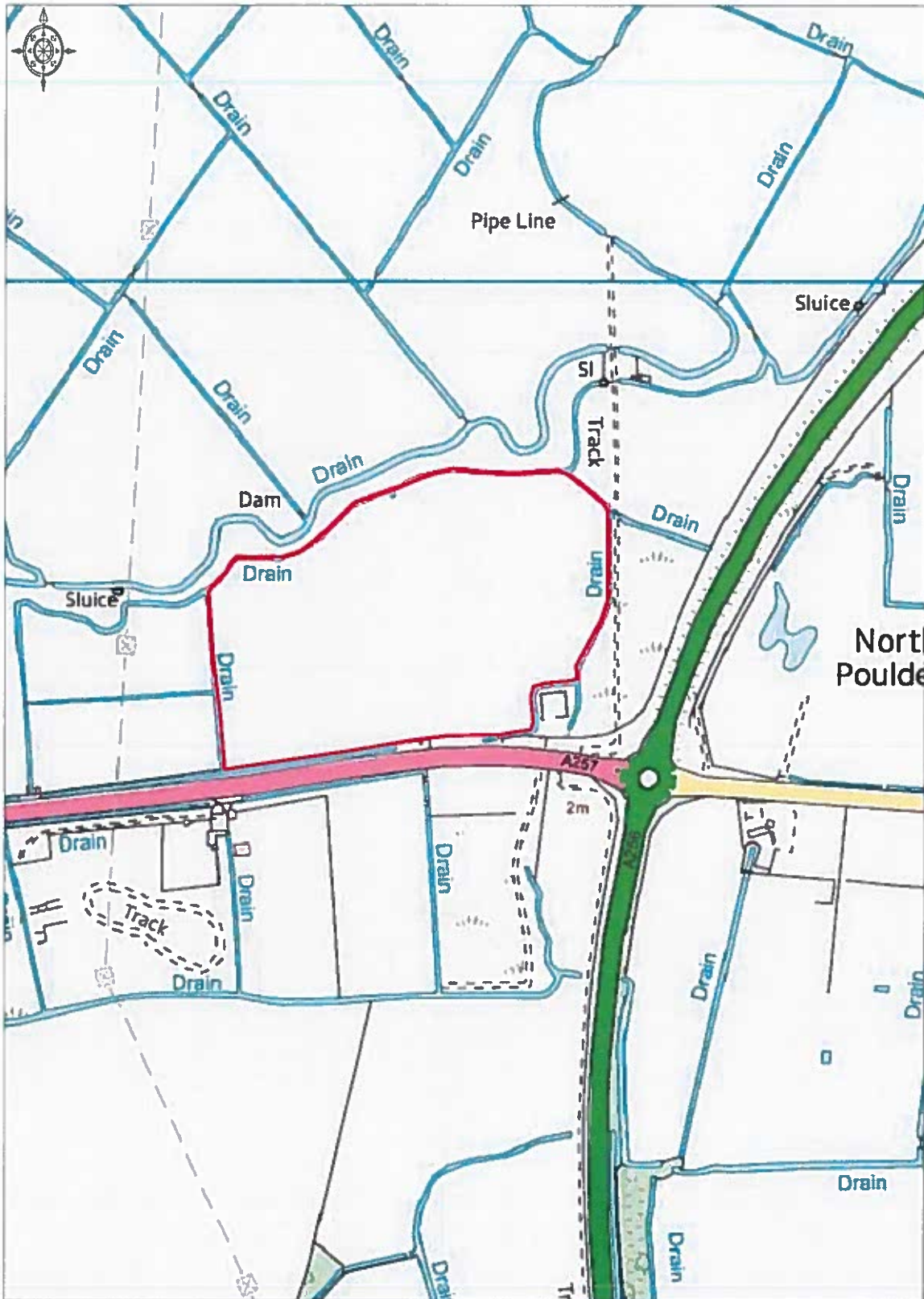

Ordnance Survey © Crown Copyright 2017. All rights reserved.  
License number 100022432. Plotted Scale - 1:5000

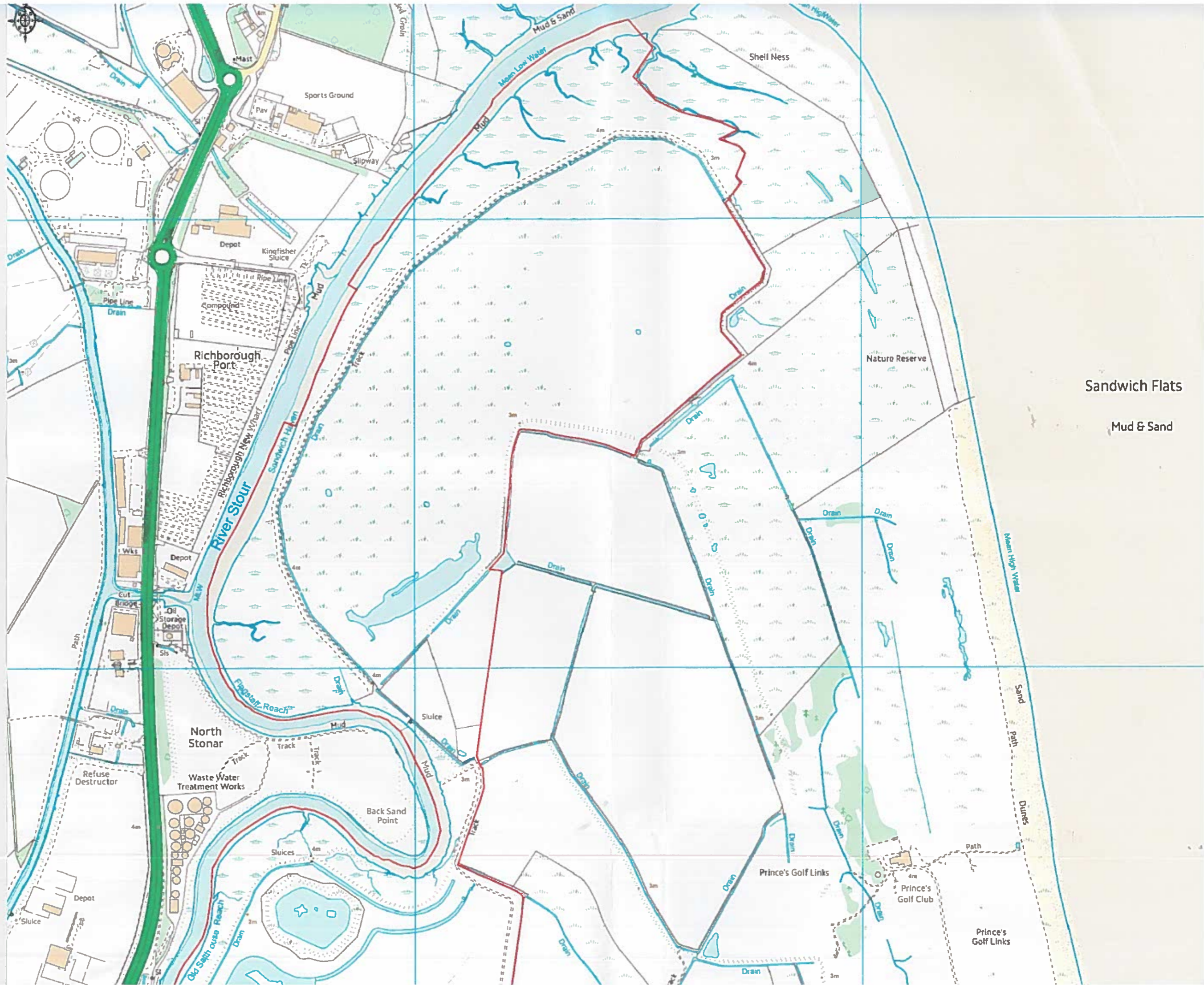

Sandwich Flats  
Mud & Sand



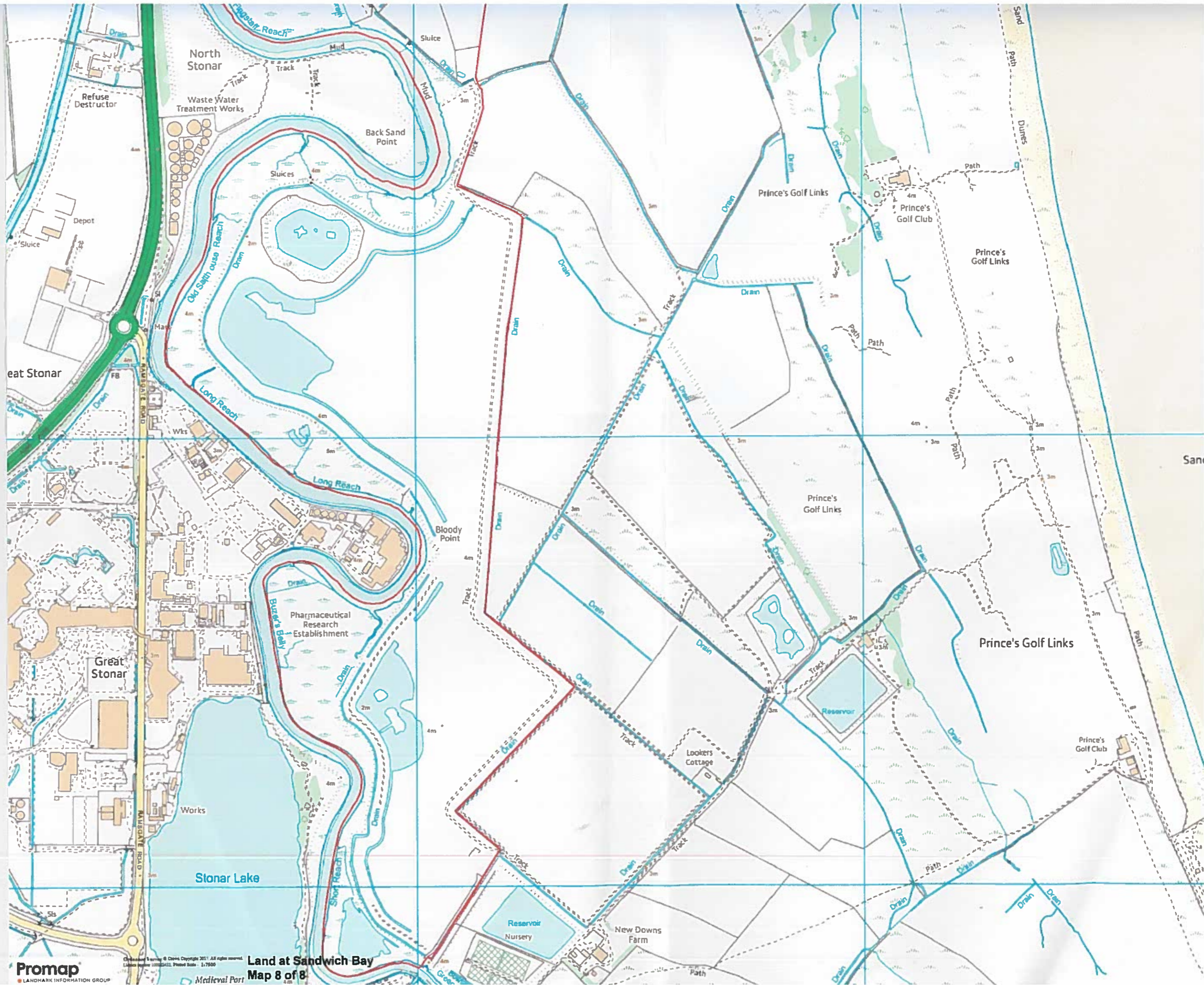

## Application Form

## Form CA16

**Application Form for deposits under section 31(6) of the Highways Act 1980 and section 15A(1) of the Commons Act 2006****Please read the following guidance carefully before completing this form**

1. *Guidance relating to completion of this form is available from <https://www.gov.uk/town-and-village-greens-how-to-register>. Please refer to these separate notes when completing this form.*
2. *Parts A and F must be completed in all cases.*
3. *The form must be signed and dated by, or by a duly authorised representative of, every owner of land to which the application relates who is an individual, and by the secretary or some other duly authorised officer of every owner of land to which the application relates which is a body corporate or an unincorporated association.*
4. *In the case of land in joint ownership all the joint owners must complete paragraphs 2 and 3 of Part A and complete and sign the application in Part F, unless a duly authorised representative completes and signs the form on behalf of all of the owners of the land. Paragraph 3 should be completed in full to clearly explain the capacity of each applicant e.g. trustee, landowner's managing agent, executor.*
5. *'Owner' is defined in section 61(3) of the Commons Act 2006 and section 31(7) of the Highways Act 1980 and means, broadly, a legal owner of the freehold interest in the land.*
6. *Where the application relates to more than one parcel of land, a description of each parcel should be included in Paragraph 4 of Part A and the remainder of the form should be completed to clearly identify which statement and/or declaration relates to which parcel of land. This may require the insertion of additional wording. See separate notes for further guidance. Multiple parcels of land should be clearly identified by coloured edging on any accompanying map.*
7. *Where a statement or declaration requires reference to colouring shown on an accompanying map or previously lodged map, the colouring must be clearly specified and must match that shown on the relevant map. For example, if a footpath is specified in a Part C declaration as shown coloured brown, the accompanying map or previously deposited map referred to must reflect that colouring.*
8. *An application must be accompanied by an ordnance map, or (in respect of declarations under Part C or statements under Part D of this form) refer to a map previously deposited in accordance with the Commons (Registration of Town or Village Greens) and Dedicated Highways (Landowner Statements and Declaration) (England) Regulations 2013 or (if deposited before 1st October 2013) in accordance with section 31(6) of the Highways Act 1980. Any accompanying map must be an ordnance map at a scale of not less than 1:10,560 showing the boundary of the land to which the application relates in coloured edging.*
9. *An application must be accompanied by the requisite fee – please ask the appropriate authority for details.*

10. 'Appropriate authority' means (a) in relation to a map or statement deposited or declaration lodged under section 31(6) of that Act, an appropriate council (as defined in section 31(7) of the Highways Act 1980); and (b) in relation to a statement and map deposited under section 15A(1) of the 2006 Act, a commons registration authority (defined in section 4 of the Commons Act 2006 and section 2 of the Commons Registration Act 1965). In practice, the appropriate council and commons registration authority will usually be the same body.

**PART A: Information relating to the applicant and land to which the application relates**  
*(all applicants must complete this Part)*

1. Name of appropriate authority to which the application is addressed: Kent County Council

2. Name and full address (including postcode) of applicant: Edward Plumptre

BTF Partnership, Clockhouse Barn, Canterbury Road, Challock, Ashford, Kent, TN25 4BJ

3. Status of applicant (tick relevant box or boxes):

I am

(a)  the owner of the land(s) described in paragraph 4.

(b)  making this application and the declaration it contains on behalf of **A.C. Hulme & Sons** who are the owner of the lands described in paragraph 4 and in my capacity as the landowners managing agent.

4. Insert description of the lands to which the application relates:

All that land shown edged in red on the map accompanying the statement deposited on 10<sup>th</sup> November 2017 with Kent County Council and described as follows:

Map 1: Pedding & Brook Field Farm (Parcel A), Brook Farm, Staple Road, Wingham, Canterbury, Kent CT3 1PL. The subject land is 237.21 Hectares (586.18 Acres) with road frontage to Staple Road, Durlock Road and A257.

Map 1: Pedding and Brook Field Farm (Parcel B), Brook Farm, Staple Road, Wingham, Canterbury, Kent CT3 1PL. The subject land is 9.00 Hectares (19.77 Acres) with road frontage St Mary's Road.

Map 2: Land at Hoaden (Parcel A), Walmestone Road, Nash, Ash, Canterbury, Kent CT3 2JX. The subject land is 5.77 Hectares (14.27 Acres) with road frontage to Walmestone Road.

Map 2: Land at Hoaden (Parcel B), Sheerwater Road, Hoaden, Ash, Canterbury, Kent CT3 1HJ. The subject land is 35.79 Hectares (88.43 Acres) with road frontage to Sheerwater Road, Church Hill and Hoaden Lane.

Map 2: Land at Hoaden (Parcel C), Sheerwater Road, Hoaden, Ash, Canterbury, Kent CT3 2LJ. The subject land is 5.65 Hectares (13.97 Acres) with road frontage to Sheerwater Road.

Map 2: Land at Hoaden (Parcel D), Sheerwater Road, Hoaden, Ash, Canterbury, Kent CT3 2LJ. The subject land is 4.85 Hectares (11.99 Acres) with road frontage to Sheerwater Road.

Map 2: Land at Hoaden (Parcel E), Hoaden Lane, Hoaden, Ash, Canterbury, Kent CT3 2LQ. The subject land is 61.48 Hectares (151.92 Acres) with road frontage to Hoaden Lane.

Map 3: Land at Westmarsh (Parcel A), Wass Drove, Westmarsh, Canterbury, Kent CT3 2LW. The subject land is 51.12 Hectares (126.34 Acres) with road frontage to Wass Drove.

Map 3: Land at Westmarsh (Parcel B), Wass Drove, Westmarsh, Canterbury, Kent CT3 2LW. The subject land is 6.36 Hectares (15.72 Acres) with road frontage to Wass Drove.

Map 4: Land at Preston (Parcel A), Grove Road, Grove, Canterbury, Kent CT3 4BL. The subject land is 32.63 Hectares (80.64 Acres) with road frontage to Grove Road.

Map 4: Land at Preston (Parcel B), The Street, Preston, Canterbury, Kent CT3 1DZ. The subject land is 8.05 Hectares (19.89 Acres).

Map 5: Land at Sand Pitts, Preston Hill, Wingham, Kent CT3 1DA. The subject land is 4.42 Hectares (10.94 Acres) with road frontage to Preston Hill.

Map 6: Land at Chartham (Parcel A), Ashford Road, Chartham, Canterbury, Kent CT4 7SE. The subject land is 48.05 Hectares (120.71 Acres) with road frontage to Ashford Road.

Map 6: Land at Chartham (Parcel B), Ashford Road, Chartham, Canterbury, Kent CT4 7NY. The subject land is 27.40 Hectares (67.71 Acres) with road frontage to Ashford Road.

Map 6: Land at Chartham (Parcel C), Shalmsford Street, Chartham, Canterbury, Kent CT4 7DJ. The subject land is 42.30 Hectares (104.52 Acres) with road frontage to Shalmsford Street.

Map 6: Land at Chartham (Parcel D), Shalmsford Street, Chartham, Kent CT4 8AG. The subject land is 13.01 Hectares (32.17 Acres) with road frontage to Shalmsford Street.

Map 6: Land at Chartham (Parcel E), Thruxted Lane, Chartham, Canterbury, Kent CT4 7RT. The subject land is 4.31 Hectares (10.66 Acres) with road frontage to Thruxted Lane and Bobbin Lodge Hill.

Map 6: Land at Chartham (Parcel F), Mysole Lane, Chartham, Canterbury, Kent CT4 7QN. The subject land is 41.49 Hectares (102.53 Acres) with road frontage to Shalmsford Street, Mystole Lane, Thruxted Lane and Bobbin Lodge Hill.

Map 7: Land at Sandwich Flats, Ash Road, Sandwich, Kent Ct13 9JB. The subject land is 5.98 Hectares (14.79 Acres).

Map 8: Land at Sandwich Bay, Ramsgate Road, Sandwich, Kent CT13 9NW. The subject land is 190.28 Hectares (470.21 Acres)

5. Ordnance Survey six-figure grid reference(s) of a point within the area of land(s) to which the application relates (if known):

Pedding and Brook Field Farm – TR259573

Land at Hoaden – TR268602

Land at Westmarsh – TR270615

Land at Preston – TR245621

Land at Sand Pitts – TR248584

Land at Chartham – TR094550

Land at Sandwich Flats – TR315587

Land at Sandwich Bay – TR338610

6. This deposit comprises the following declaration:

**PART C: Declaration under section 31(6) of the Highways Act 1980**

1. A C Hulme & Sons are the owner of the land described in paragraph 4 of Part A of this form and shown edged in red on the map lodged with Kent County Council on 10<sup>th</sup> November 2017.

2. On the 10<sup>th</sup> day of November 2017 A C Hulme & Sons deposited with Kent County Council, being the appropriate council, a statement accompanied by a map showing A C Hulme & Sons' property shown edged in red which stated that:

the ways shown blue on that map had been dedicated as restricted byways

the ways shown green on that map had been dedicated as bridleways

the ways shown purple on that map had been dedicated as footpaths

no other ways had been dedicated as highways over A C Hulme & Sons' property.

3. No additional ways have been dedicated over the land shown edged in red on the maps referenced in paragraph 1 above since the statement dated 10<sup>th</sup> November 2017 referred to in paragraph 2 above and at the present time A C Hulme & Sons have no intention of dedicating any more public rights of way over the property.

**PART F: Statement of Truth**  
*(all applicants must complete this Part)*

**WARNING:** If you dishonestly enter information or make a statement that you know is, or might be, untrue or misleading, and intend by doing so to make a gain for yourself or another person, or to cause loss or the risk of loss to another person, you may commit the offence of fraud under section 1 of the Fraud Act 2006, the maximum penalty for which is 10 years' imprisonment or an unlimited fine, or both.

**I BELIEVE THAT THE FACTS AND MATTERS CONTAINED IN THIS FORM ARE TRUE**

Signature (of the person making the statement of truth):



Print full name: Edward Plumtre, BTF Partnership

Date: 27/11/2017

You should keep a copy of the completed form

**Data Protection Act 1998 - Fair Processing Notice**

The purpose of this Fair Processing Notice is to inform you of the use that will be made of your personal data, as required by the Data Protection Act 1998.

The appropriate authority (see explanation of definition in above guidance notes) in England is the data controller in respect of any personal data that you provide when you complete this form.

The information that you provide will be used by the appropriate authority in its duties to process applications to deposit statements, maps and declarations under section 31(6) the Highways Act 1980 and

statements under section 15A(1) of the Commons Act 2006. The information you provide will also be used by the appropriate authority in its duty to update the registers in which details of such deposits are recorded under the Dedicated Highways (Registers under Section 31A of the Highways Act 1980) (England) Regulations 2007 and the Commons (Registration of Town or Village Greens) and Dedicated Highways (Landowner Statements and Declarations) (England) Regulations 2013.

The appropriate authority is required by the legislation above to maintain a register which holds information provided in this form, which can be inspected online or in person by members of the public on request. It may also be required to release information, including personal data and commercial information, on request under the Environmental Information Regulations 2004 or the Freedom of Information Act 2000. However, the appropriate authority will not permit any unwarranted breach of confidentiality nor will they act in contravention of their obligations under the Data Protection Act 1998.