

Rathmore Road, Gravesend

Link Road Improvement Scheme



Rathmore Road, Gravesend

Link Road Improvement Scheme



Site Offices and Compound

Planning permission has been granted for temporary use of the southern end of Lord Street car park for a site compound. Jackson Civil Engineering and our engineering consultants - Amey - will have offices located here from which they will manage the works. It is the same area that was used a few years ago for a compound when the Community Square works were carried out. This part of the car park will no longer be available from Monday 2 May to allow the offices to be set up before the main construction works start in June but 50% of the parking spaces will remain on the north part of the site.

Car Parking

During the construction period when Rathmore Road car park is unavailable, the nearest alternative parking will be in Parrock Street car park where there is significant spare capacity. 14 additional blue badge spaces have now been provided. Details of town centre car parks and charges can be found at <http://www.gravesham.gov.uk/services/transport-and-streets/parking/car-parks/car-park-locations-and-charges>.

Gravesend Station Cycle Hub

While not part of the scheme you may be aware of the start of works by South Eastern Trains for the construction of an enclosed and secure cycle parking facility for some 280 cycles. It will be located on the south side of the Station and towards the Darnley Road side and is planned to open in summer 2016.

Keeping the local community and drivers informed

Our aim is to construct the scheme as efficiently and quickly as possible whilst minimising disruption to traffic, and impacts on the operation of the town centre and railway station.

We will keep people informed by a variety of means as follows:

- Signs on site
- KCC Website - link is www.kent.gov.uk/rathmore-road-link
- Further Newsletters
- e mail to those who responded to Newsletter No. 1 and asked to be kept updated in that way
- Information to the Borough Council and available at the Civic Centre Reception
- Information within the Station entrances.

Jackson Civil Engineering will also have a dedicated person based at the site offices to manage the flow of information and to deal with any queries. Contact details will be provided once the offices are established and we have an allocated telephone number and e mail address. In the meantime you can continue to contact us as indicated at the bottom of this Newsletter.

Finally...

When we have more detailed information about the construction programme and traffic and pedestrian management arrangements we will share this with you.

Newsletter 2 April 2016

Finance

- Estimated cost - £9.5m
- Funding Kent Thameside Strategic Transport Improvement Programme £5.3m
- South East Local Enterprise Partnership Local Growth Funding - £4.2m

Start of work getting closer



The first Newsletter - circulated in November last year - gave background information about the proposals for the new Rathmore Road Link, improvements to Clive Road and changes to Railway Place. This information is repeated for your convenience in the centre pages.

It is now time for a further update.

Funding Confirmed

The South East Local Enterprise Partnership has confirmed the release of Local Growth Funding for the scheme to complement other government funding already provided through the Kent Thameside Strategic Transport Improvement Programme.

Construction Contract Awarded

A construction contract has now been awarded to Jackson Civil Engineering. They are a firm that have done many road projects in Kent and have particular experience in town centre schemes with public realm improvements.

Construction will start in June and continue for about 18 months until works are completed towards the end of 2017.

Advance Works

Rathmore Road car park will be closed from Monday 4 April. This is to allow archaeological investigations to take place to see whether anything can be revealed about the past use of the area to add to our knowledge of the history of Gravesend

Trees that have to be removed for the scheme are being cut down now before the start of the bird nesting season.

Newsletter 2 April 2016

Work to Date

- Planning permission for scheme
- Planning permission for site compound
- Land secured
- Funding secured
- Construction contract awarded

Proposed Programme

- Archaeological investigation - April-May 2016
- Work starts - June 2016
- Construction completed - December 2017
- Monitor scheme operation - December 2017 onwards
- Clear construction compound - Spring 2018.
- Bridge strengthening at Railway Place - May-June.

Rathmore Road, Gravesend

Link Road Improvement Scheme

What does the scheme involve?

The Link Road will be a new two way road. It will include wide footways on either side to provide a shared cycleway link between the Civic Square and the station with a signal controlled crossing. Traffic signals will be provided at Wrotham Road and Darnley Road junctions to control the movement of traffic and pedestrians.

The Link Road crosses the existing Rathmore Road car park. The new road will leave a smaller car park of 64 spaces including at least 6 disabled spaces.

A new footway ramp will provide a pedestrian connection from the car park to the Link Road.

No. 13 Darnley Road will need to be demolished and a new end wall provided to No. 15

A new forecourt will be provided on the south side of the station in high quality materials. The area will provide room for the drop off and pick up of passengers, a taxi stand and 5 disabled parking spaces.

An acoustic fence will be provided along the northern boundary of the car park to reduce traffic noise for residents of Cobham Street.

There will be a brick or stone faced retaining wall behind the southern footway and a landscaped earth

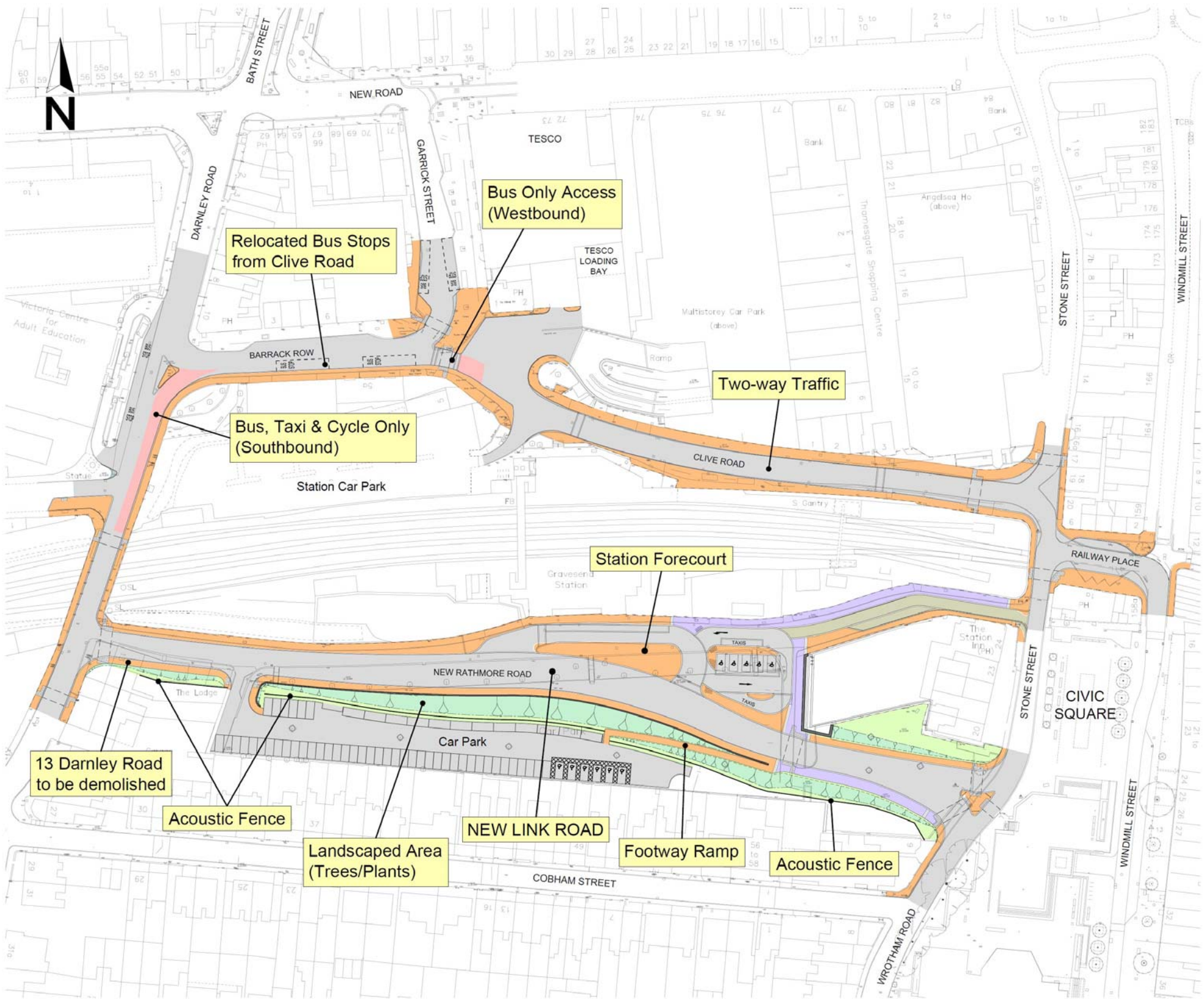

slope between the Link Road and the car park.

Rathmore Road between Stone Street and the station will be improved using high quality materials and trees to provide a pedestrian and cycling route. The road will also provide access to No. 24 Stone Street and the station yard.

Clive Road will become a cul de sac with a connection to Barrack Row for bus use only. It will continue to provide local access to the north side of the station, station car park and premises; and Thamesgate car park and rear servicing yards.

The footways, kerbs and some sections of carriageway along Clive Road will be upgraded to provide a high standard of public realm. Traffic signals will be provided at the junction with Stone Street to control the movement of traffic and to provide controlled pedestrian crossings.

Railway Place will be locally improved to accommodate the movements of heavy goods vehicles as a result of Clive Road becoming two-way.

Barrack Row together with Garrick Street will be limited to bus use and vehicles serving frontage premises. The southern footway will be widened to allow the relocation of bus stops from Clive Road. This will provide a public transport focus at Barrack Row and Garrick Street.

St. James's Road junction with Darnley Road will be made exit only to avoid the risk of an increase in traffic.